



- No waiting & No loading at any time.
- No waiting & No loading at any time, except goods vehicles.
- No waiting at any time.
- No loading. No waiting at any time.
- No waiting & No loading (except goods vehicles Excluding dual purpose vehicles).
- No waiting.
- No waiting at any time.
- No waiting at any time.
- No waiting.
- No waiting.
- No waiting.
- No waiting.
- No waiting.
- No waiting.
- No waiting.

East Dunbartonshire Council
 Sustainable Transport
 www.eastdunbarton.gov.uk

<p> Scale: 1:1000 Date: May 2012 Author: JGM </p>	<p> Plan No: B8-TC-01 </p>
--	---

This map is copyright of East Dunbartonshire Council. It is provided as a service to the public. It is not to be used for any other purpose without the written consent of East Dunbartonshire Council.

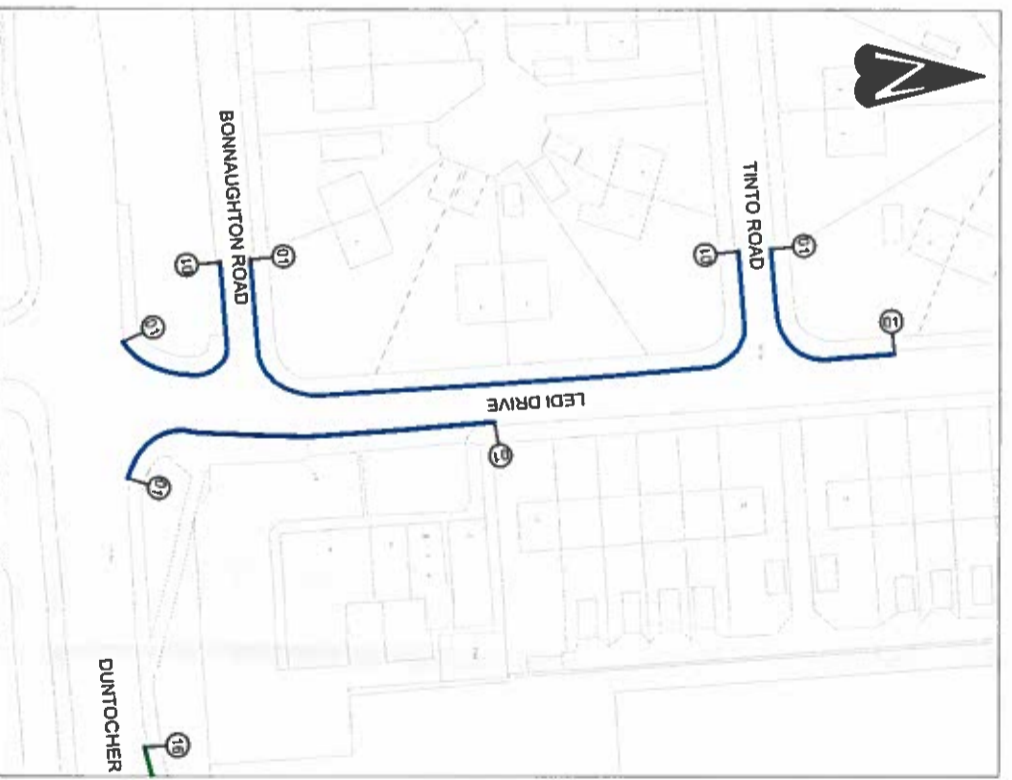
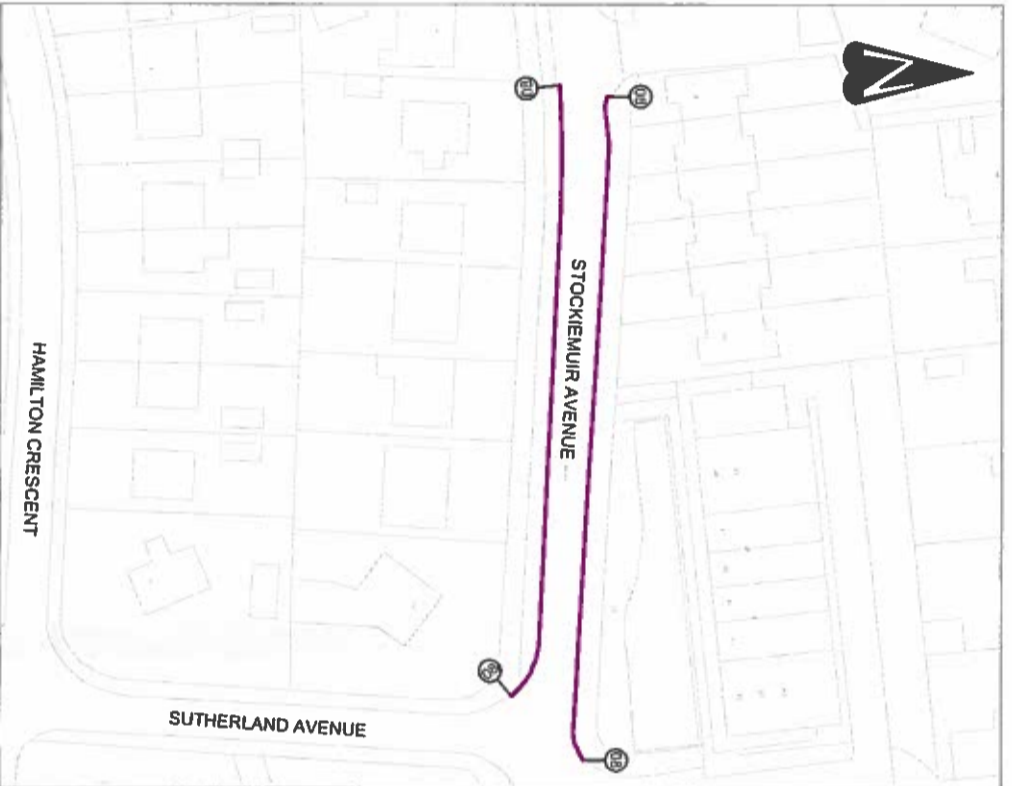
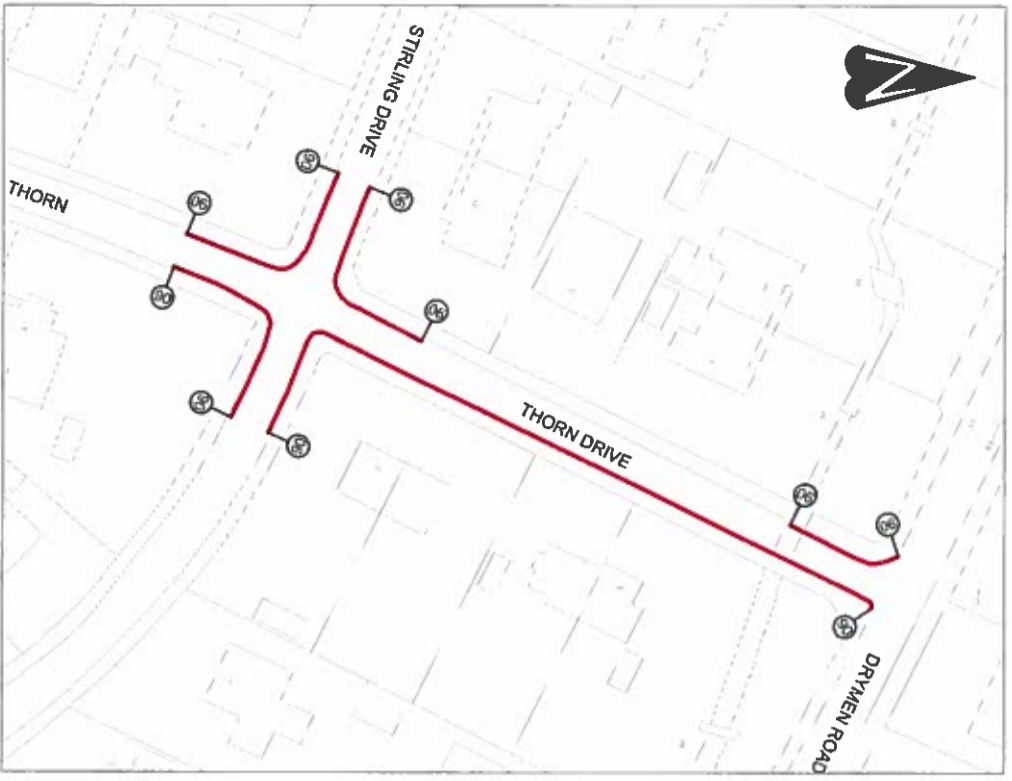
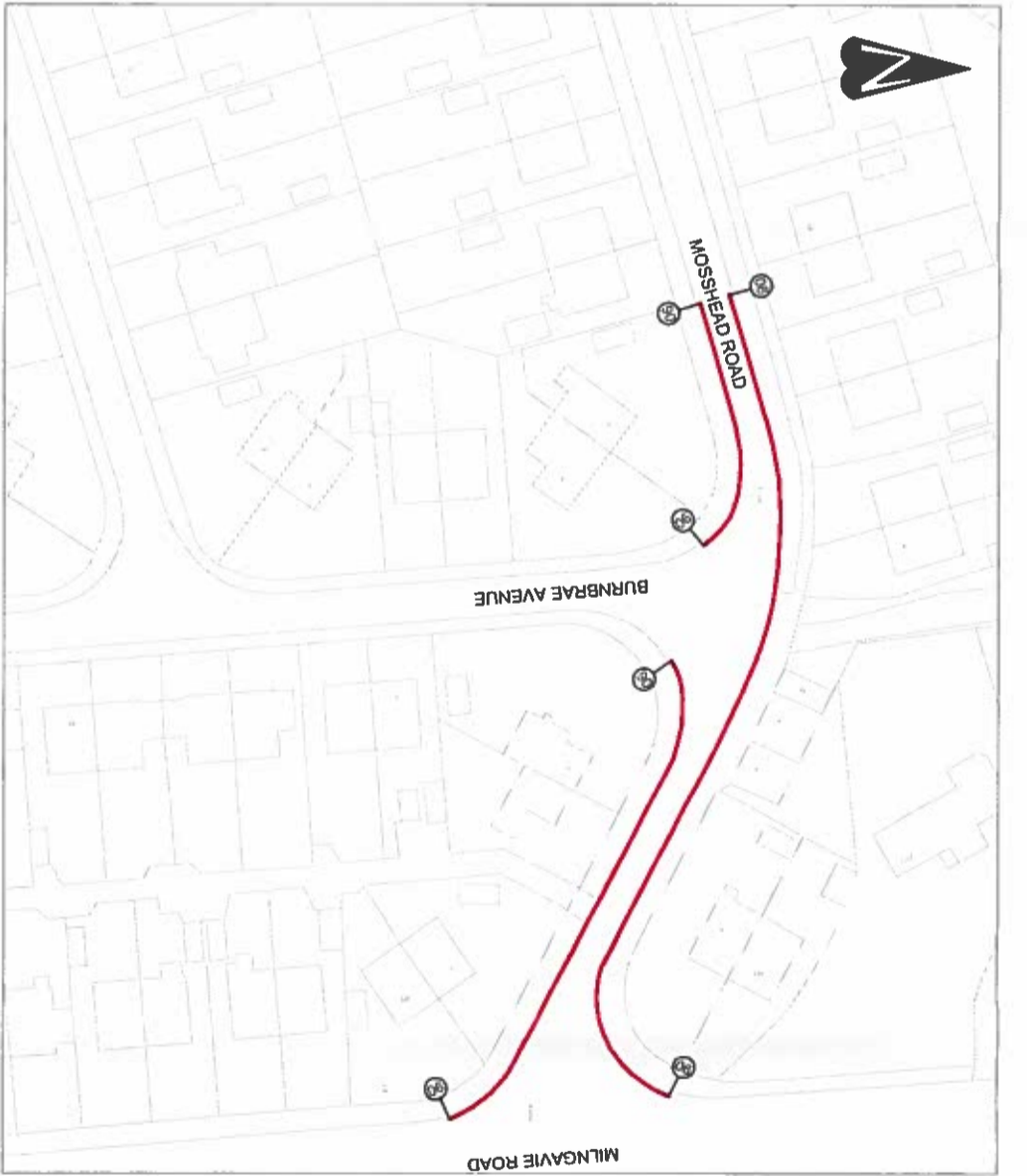
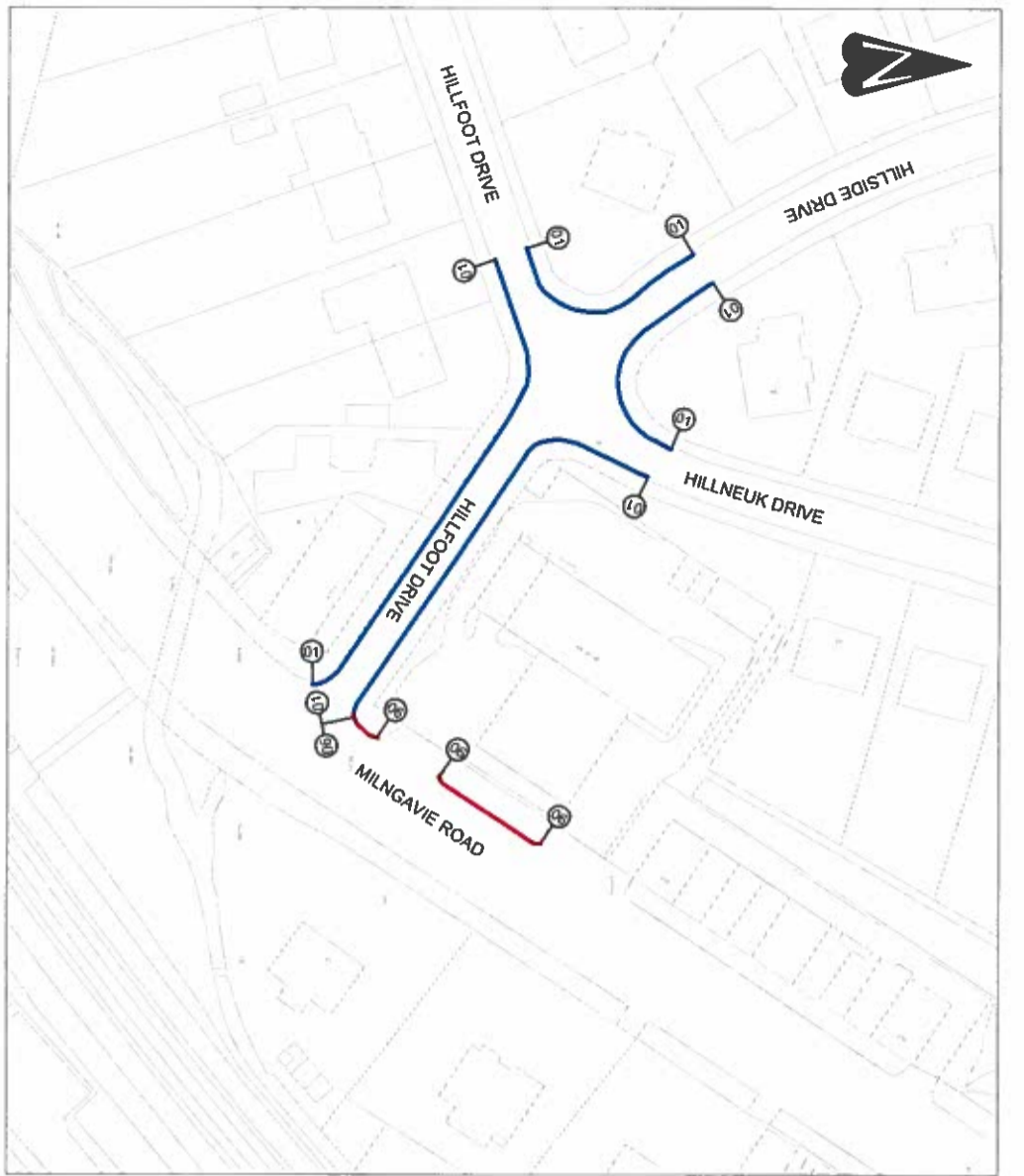





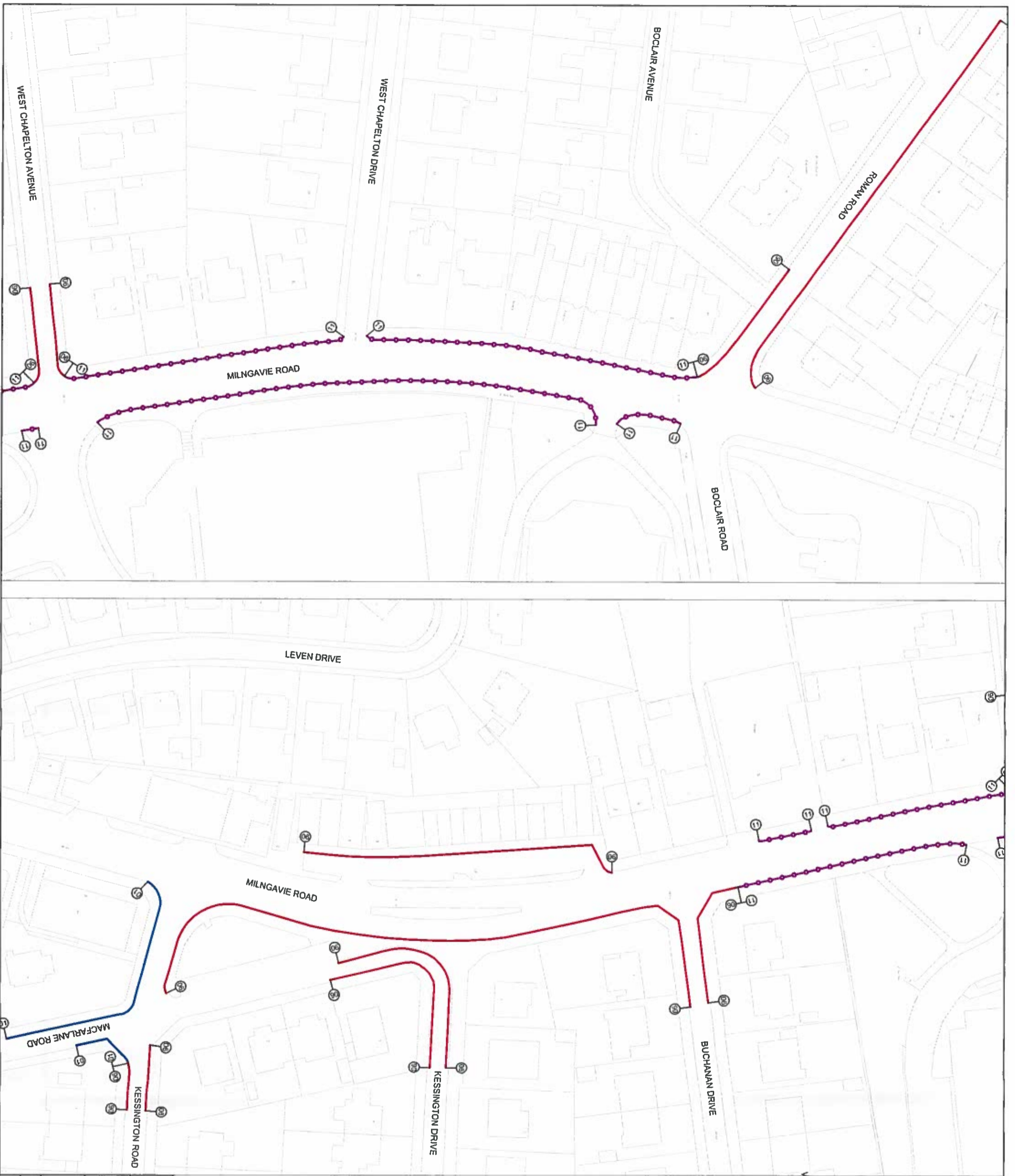

- 16-20 No waiting & No loading at any time.
- 21-25 No waiting at any time.
- 26-30 No waiting 8am - 10pm. Monday to Sunday.
- 31-35 No waiting 8am - 9:30am, 4:30pm - 6:30pm. Mondays - Fridays.
- 36-40 Waiting limited to 1 hour at any time. Return prohibited within 4 hours.
- 41-45 Waiting limited to 2 hours. 8am - 6pm. Mondays to Saturdays. Return prohibited within 1 hour.
- 46-50 No Stopping Except Buses.

East Dunbartonshire Council
 sustainable driving achieving
 www.eastdunbarton.gov.uk

DATE	2012	DRAWN BY	JGM	SCALE	1:1,000	OS REF	
FILE REF		DWG No.	Be-OTC-01	REVISION			









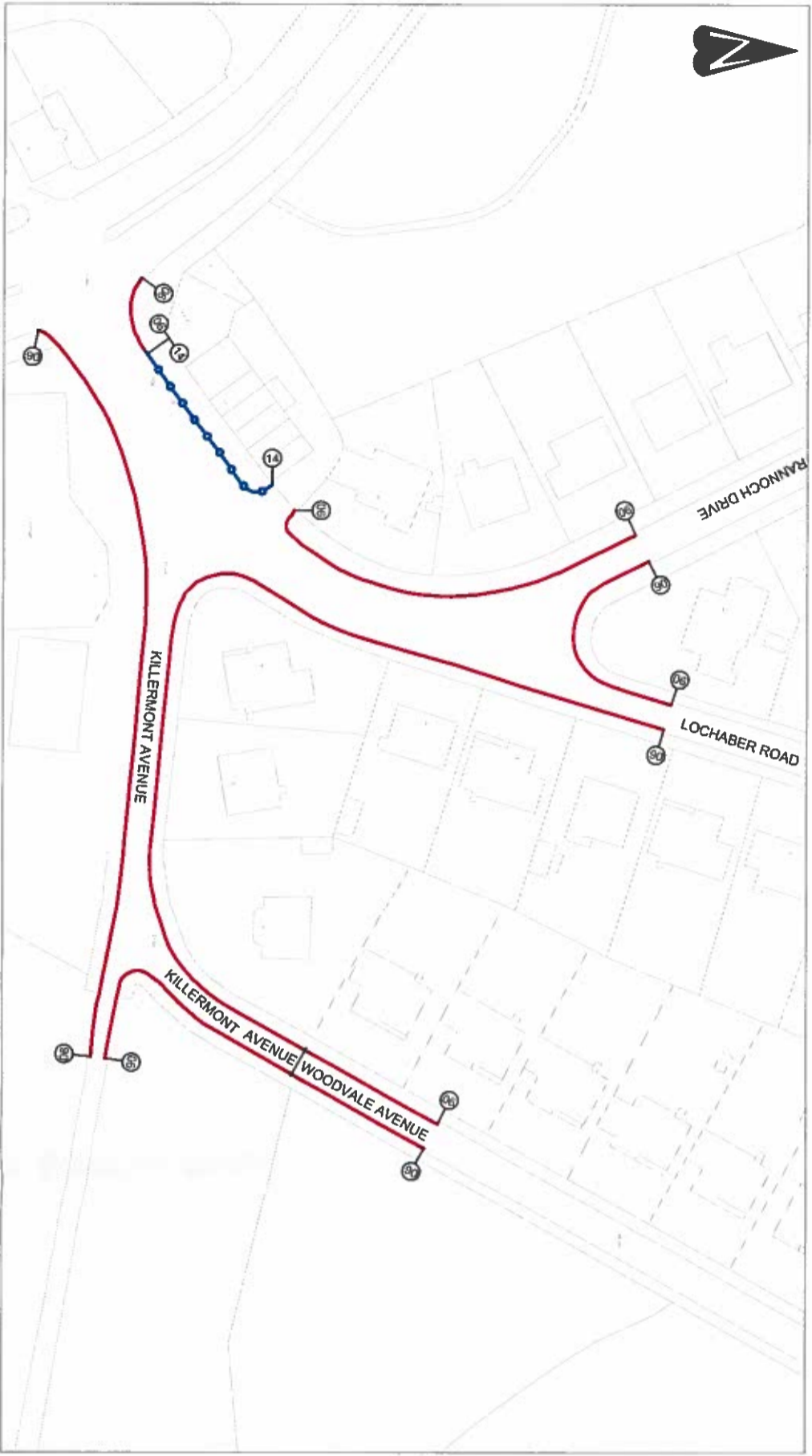
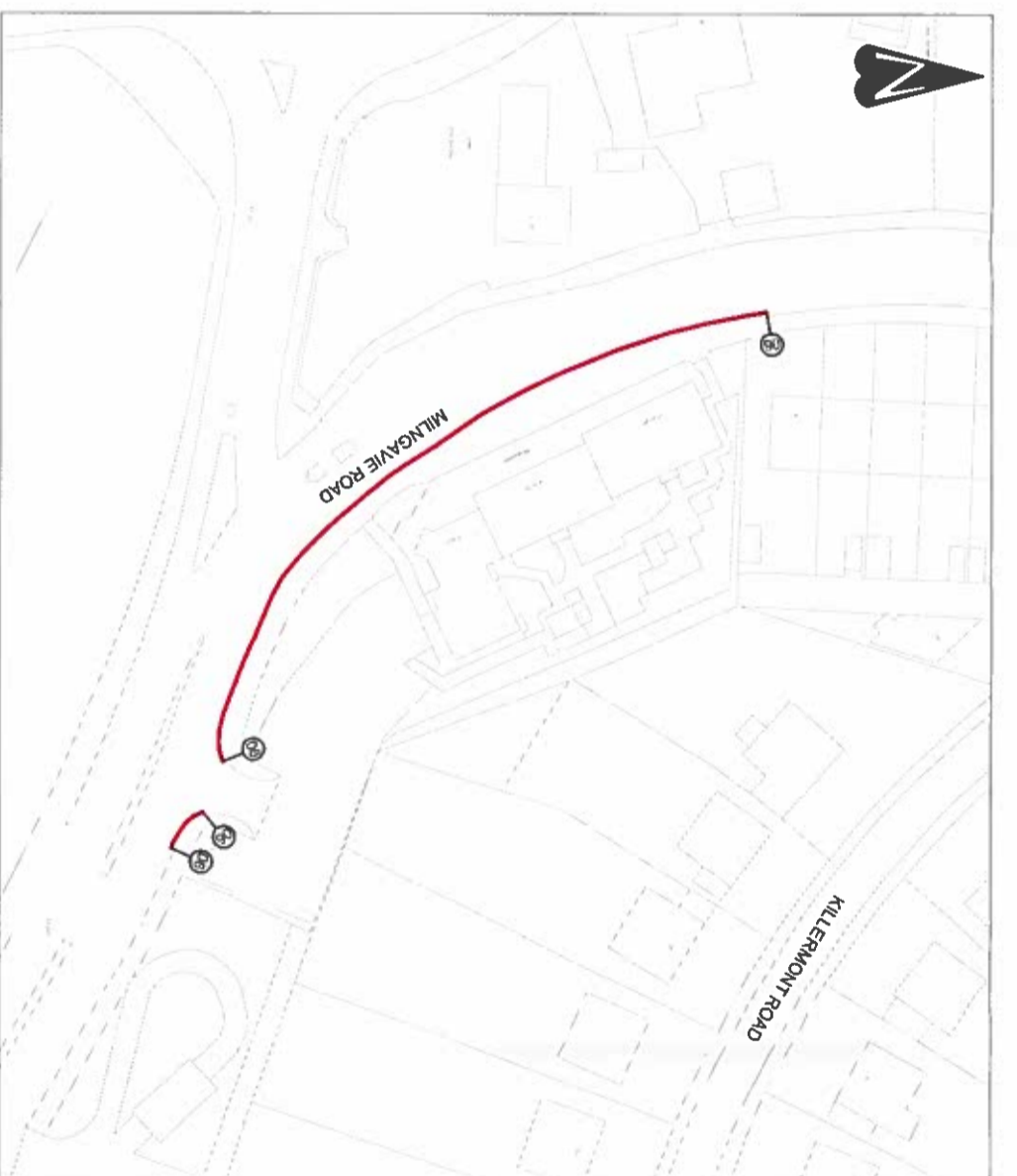
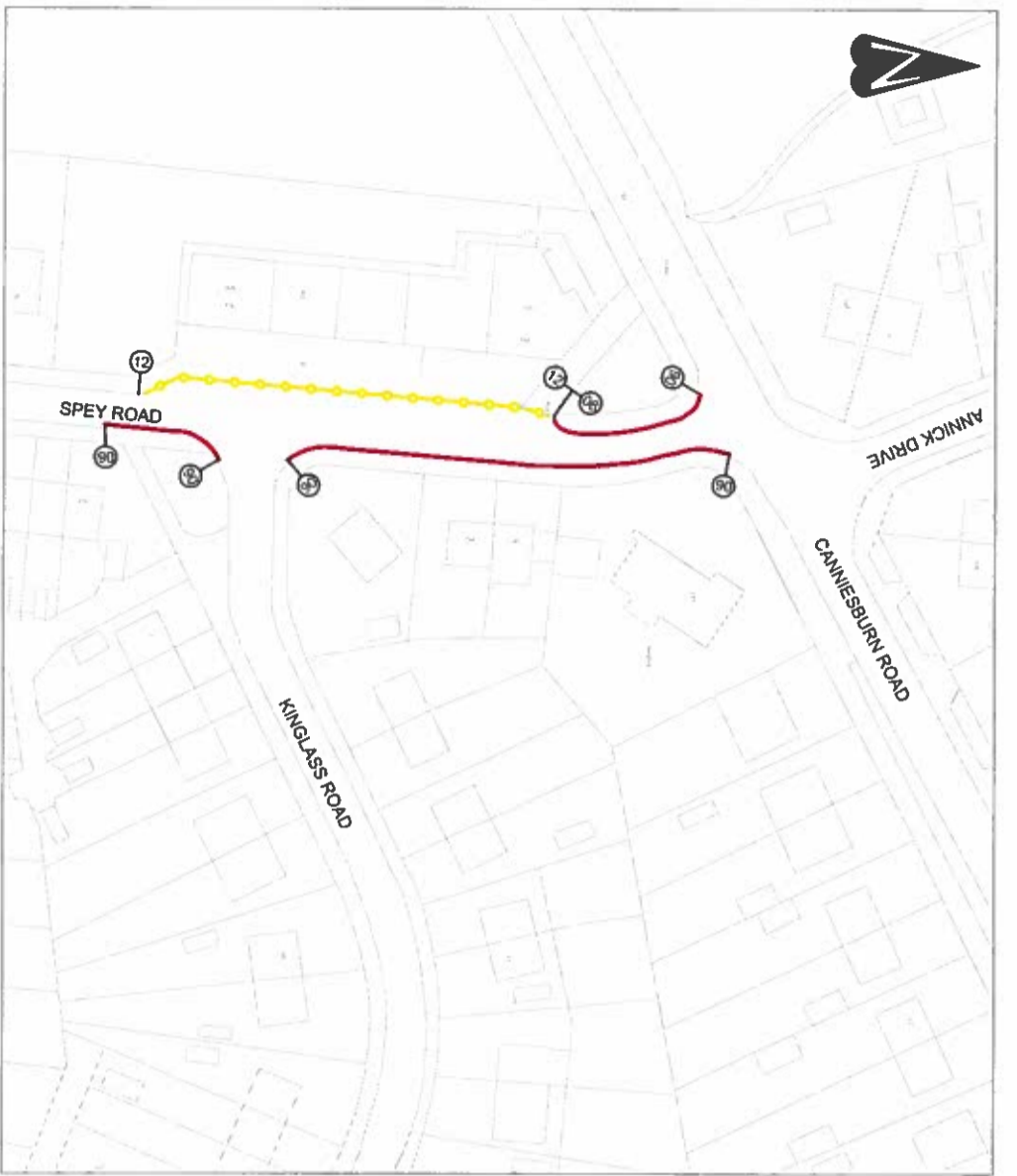

- No waiting & No loading at any time. 
- No waiting at any time. 
- No waiting 8am - 10pm, Monday to Sunday. 
- No waiting 8am - 9:30am, 4:30pm - 6:30pm, Mondays - Fridays. 
- Waiting limited to 1 hour at any time, Return prohibited within 4 hours. 
- Waiting limited to 2 hours 8am - 6pm, Mondays to Saturdays, return prohibited within 1 hour. 
- No Stopping Except Buses. 

East Dunbartonshire Council
 sustainable thriving achieving
 www.eastdunbarton.gov.uk

Bearsden Quicwh Town Centre
 Consolidation of Traffic Regulation Orders
 DATE: 2012
 DRAWN BY: JGM
 SCALE: 1:1,000
 OS REF: Be-OTC-02
 REVISION:

This map is reproduced from Ordnance Survey material with the permission of Ordnance Survey on behalf of the Controller of Her Majesty's Stationery Office. © Crown Copyright. Unauthorised reproduction infringes Crown Copyright and may lead to prosecution or civil proceedings. (10001274) 2012.



-  No waiting & No loading at any time.
-  No waiting at any time.
-  No waiting
8am - 10pm,
Monday to Sunday
-  No waiting
8am - 9:30am, 4:30pm - 6:30pm
Mondays - Fridays
-  Waiting limited to 1 hour at any time
Return prohibited within 4 hours.
-  Waiting limited to 2 hours
8am - 6pm
Mondays to Saturdays
return prohibited within 1 hour.
-  No Stopping
Except Buses

The map is reproduced from Ordnance Survey material with the permission of Ordnance Survey on behalf of the Controller of Her Majesty's Stationery Office. © Crown Copyright. (100020794, 2011)

© Crown Copyright. All rights reserved (100020794, 2011)

sustainable driving achievements

East Dunbartonshire Council
www.eastdunbarton.gov.uk

Beardsden Quirwith Town Centre
Consolidation of Traffic Regulation Orders

DATE 2012	DRAWN BY	JGM	SCALE	1:1000	D.S. REF.	
FILE REF.		DWG. NO.	Be-OTC-03	REVISION			

Mecher

PLAN NO.	Ba-OTC-PYL-01
DATE	June 13
DRAWN BY	JGM
SCALE	1:1000
Bearsden Ourwith Town Centre New & Revised Parking Restrictions Milngavie Road (A81), Roman Drive & Hillfoot Drive	
 East Dunbartonshire Council sustainable thriving achieving www.eastdunbarton.gov.uk	
<small>This map is prepared from Ordnance Survey's latest available data and is not intended to be used for navigation or other purposes. The Council of East Dunbartonshire Council is not responsible for any loss or damage arising from its use.</small>	
No waiting & No loading at any time.	
	
Waiting limited to 2 hours 8am - 6pm Mondays to Saturdays return prohibited within 1 hour.	
	

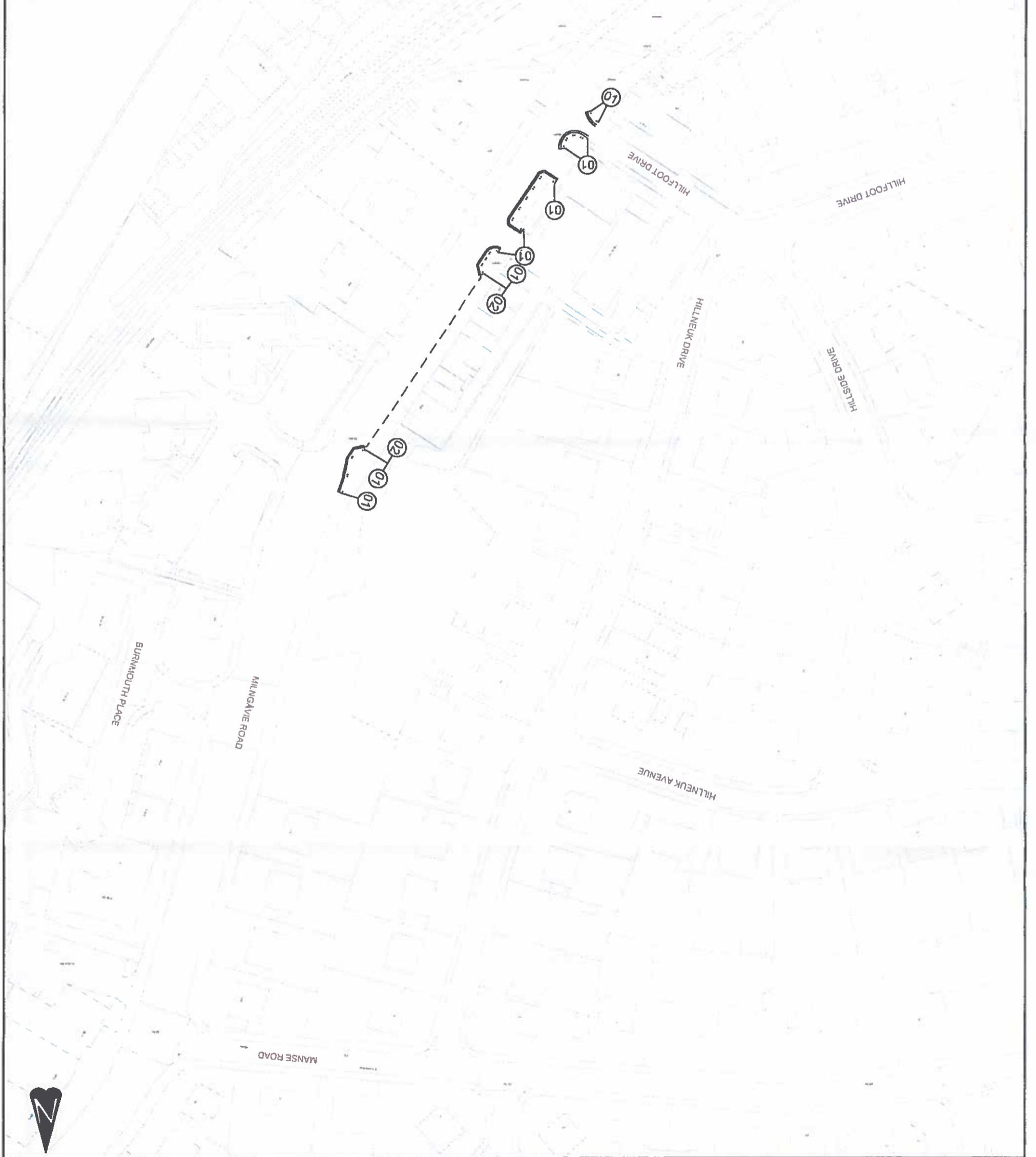

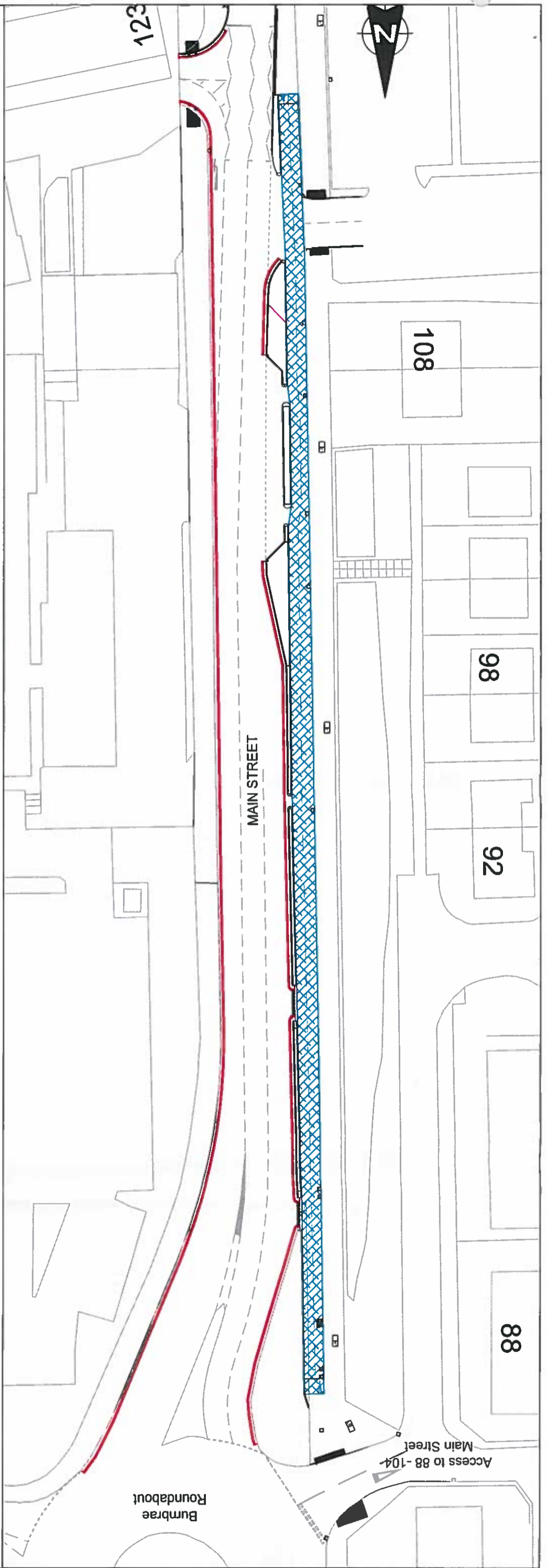
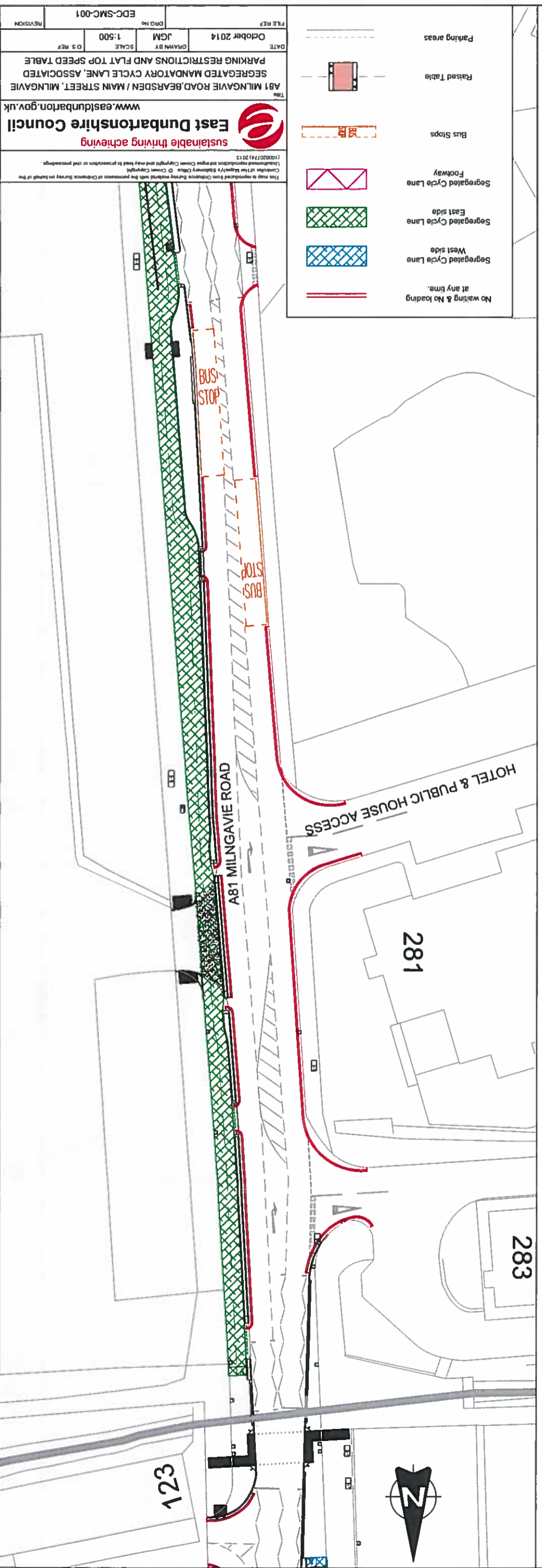

FILE REF: EDC-SMC-002
 DATE: October 2014
 DRAWN BY: JGM
 SCALE: 1:500
 O.S. REF:

East Dunbartonshire Council
 sustainable thriving achieving
 www.eastdunbarton.gov.uk

This map is reproduced from Ordnance Survey with the permission of Ordnance Survey on behalf of the Controller of Her Majesty's Stationery Office. © Crown Copyright. (100020774) 2013
 Unauthorised reproduction infringes Crown Copyright and may lead to prosecution or civil proceedings.

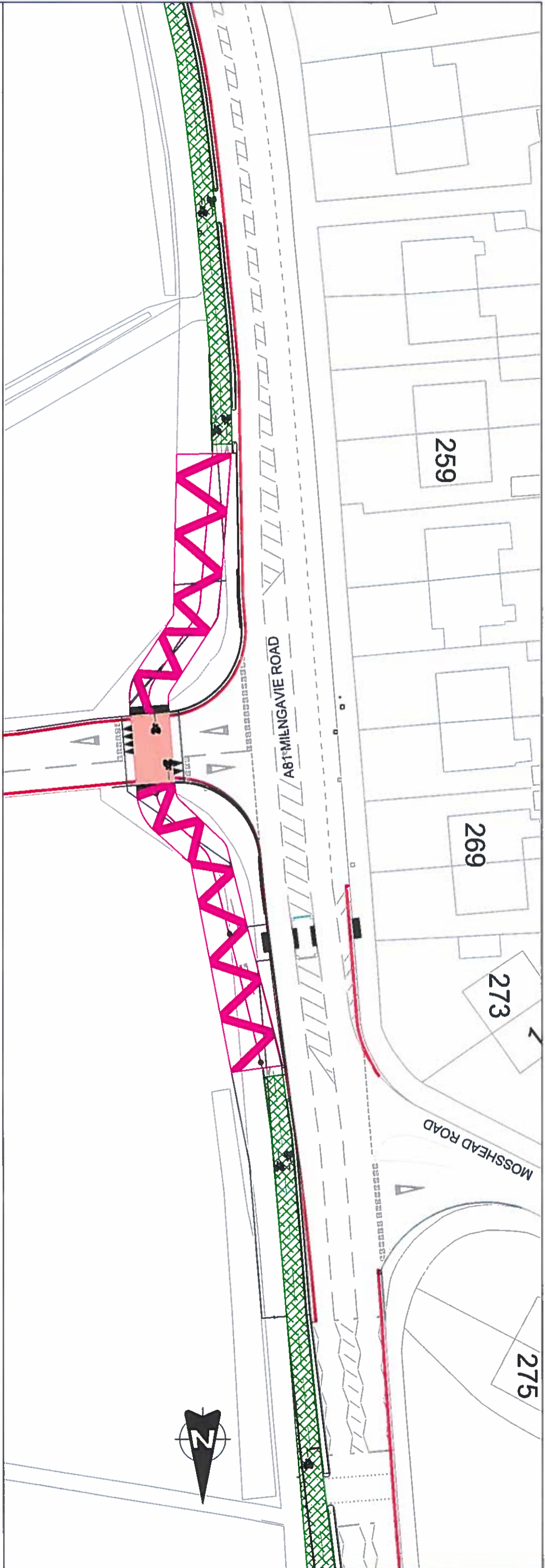
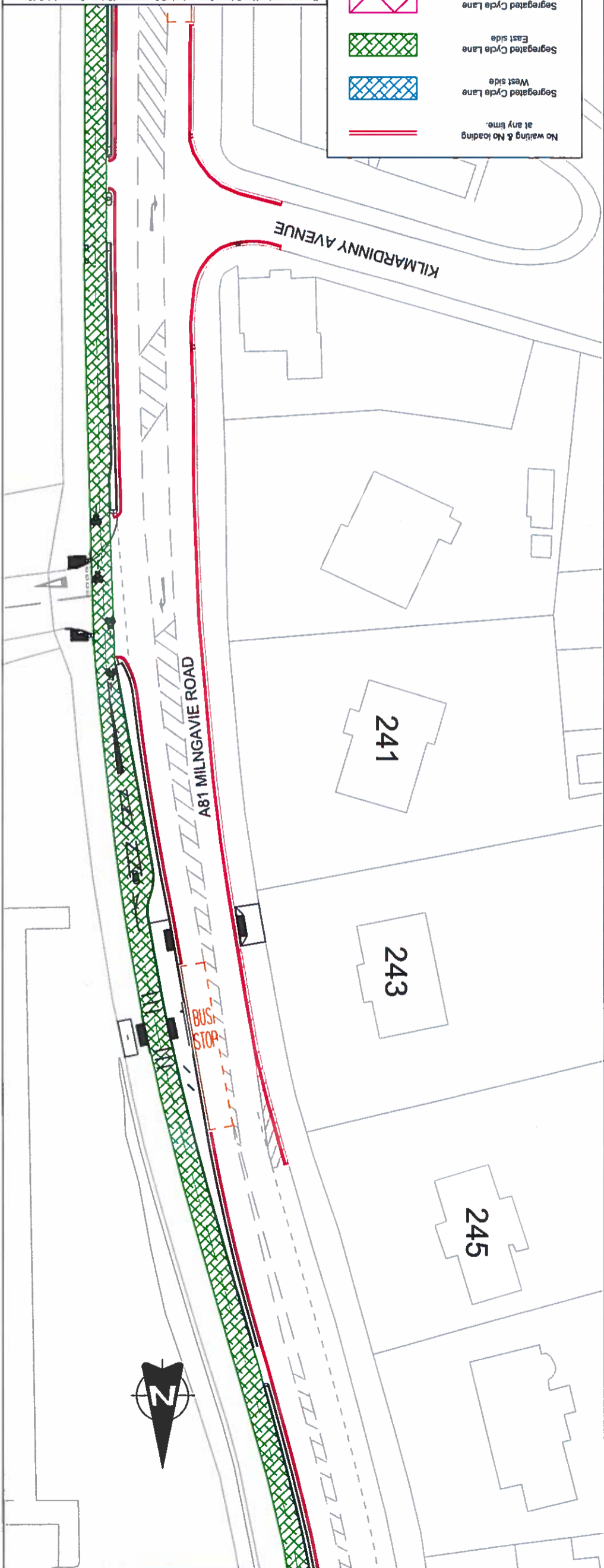

- No waiting & No loading at any time.
- Segregated Cycle Lane West side
- Segregated Cycle Lane East side
- Footway
- Bus Stops
- Raised Table
- Parking areas







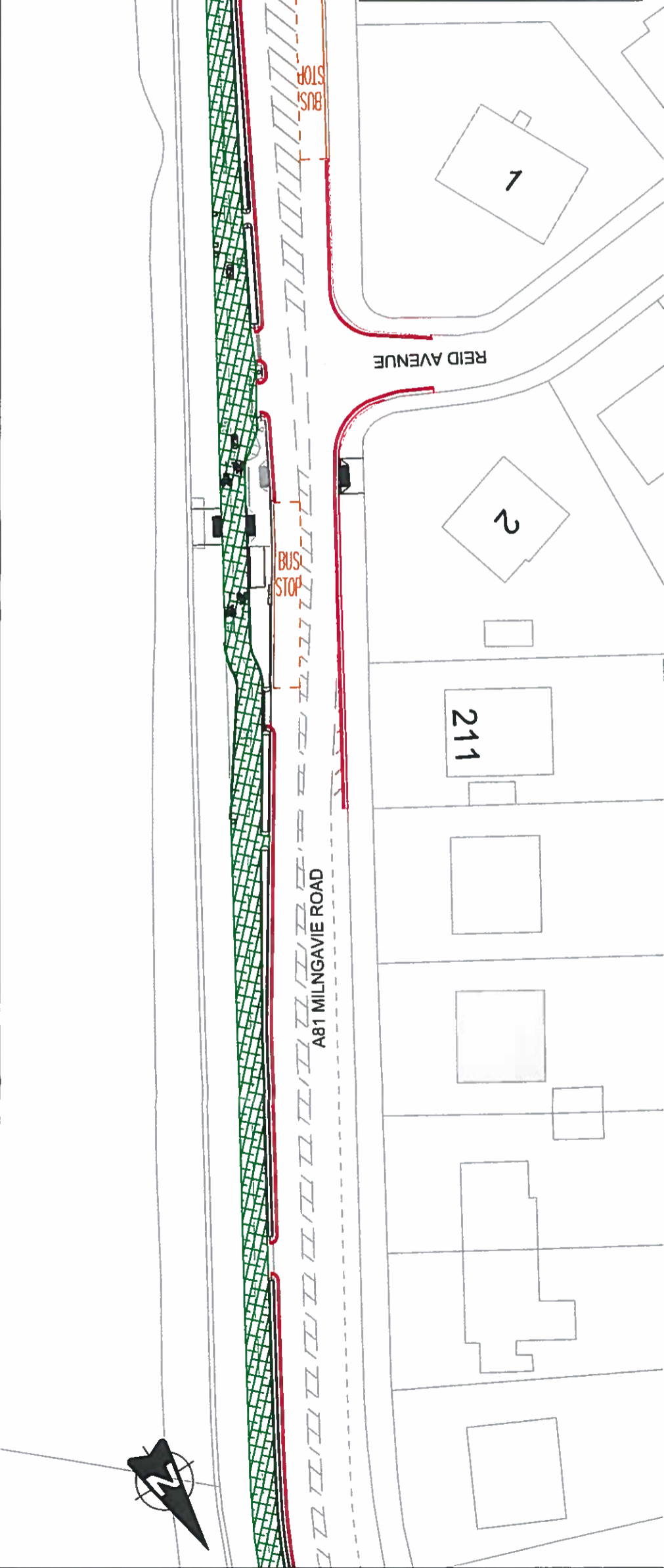

FILE REF: EDC-SMC-003
 DATE: October 2014
 DRAWN BY: JGM
 SCALE: 1:500
 REVISION:

East Dunbartonshire Council
 sustainable thriving achieving
 www.eastdunbarton.gov.uk
 A81 MILNGAVIE ROAD, BEARDSDEN / MAIN STREET, MILNGAVIE
 SEGREGATED MANDATORY CYCLE LANE, ASSOCIATED
 PARKING RESTRICTIONS AND FLAT TOP SPEED TABLE

	Parking areas
	Raised Table
	Bus Stops
	Footway
	Segregated Cycle Lane East side
	Segregated Cycle Lane West side
	No waiting & no loading at any time.



FILE REF	EDC-SMC-004
DATE	October 2014
DRAWN BY	JGM
SCALE	1:500
O/S REF	
SEGREGATED MANDATORY CYCLE LANE, ASSOCIATED PARKING RESTRICTIONS AND FLAT TOP SPEED TABLE	
A81 MILNGAVIE ROAD BEARSDEN / MAIN STREET, MILNGAVIE	
www.eastdunbarton.gov.uk	
East Dunbartonshire Council	
<i>sustainable thriving achieving</i>	
<small>This map is reproduced from Ordnance Survey material with the permission of Ordnance Survey on behalf of the Controller of Her Majesty's Stationery Office. © Crown Copyright. Licence number: 100020741/2013</small>	

	No waiting & No loading at any time.
	Segregated Cycle Lane West side
	Segregated Cycle Lane East side
	Segregated Cycle Lane Footway
	Bus Stops
	Raised Table
	Parking areas

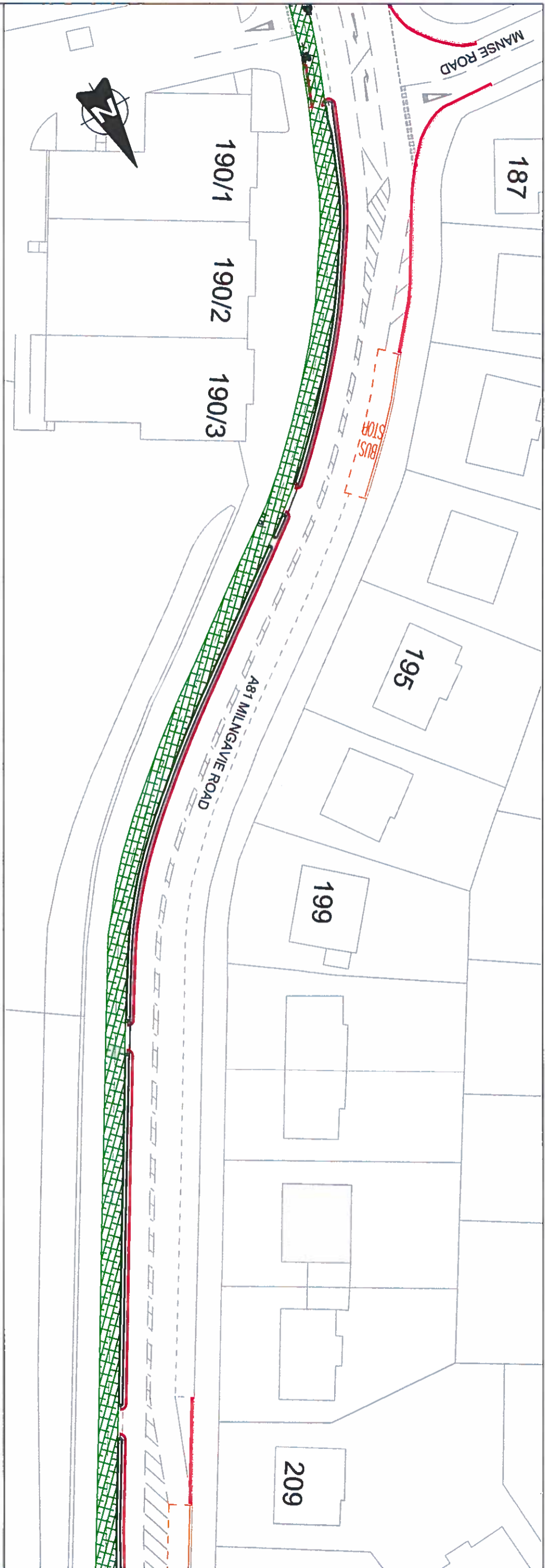
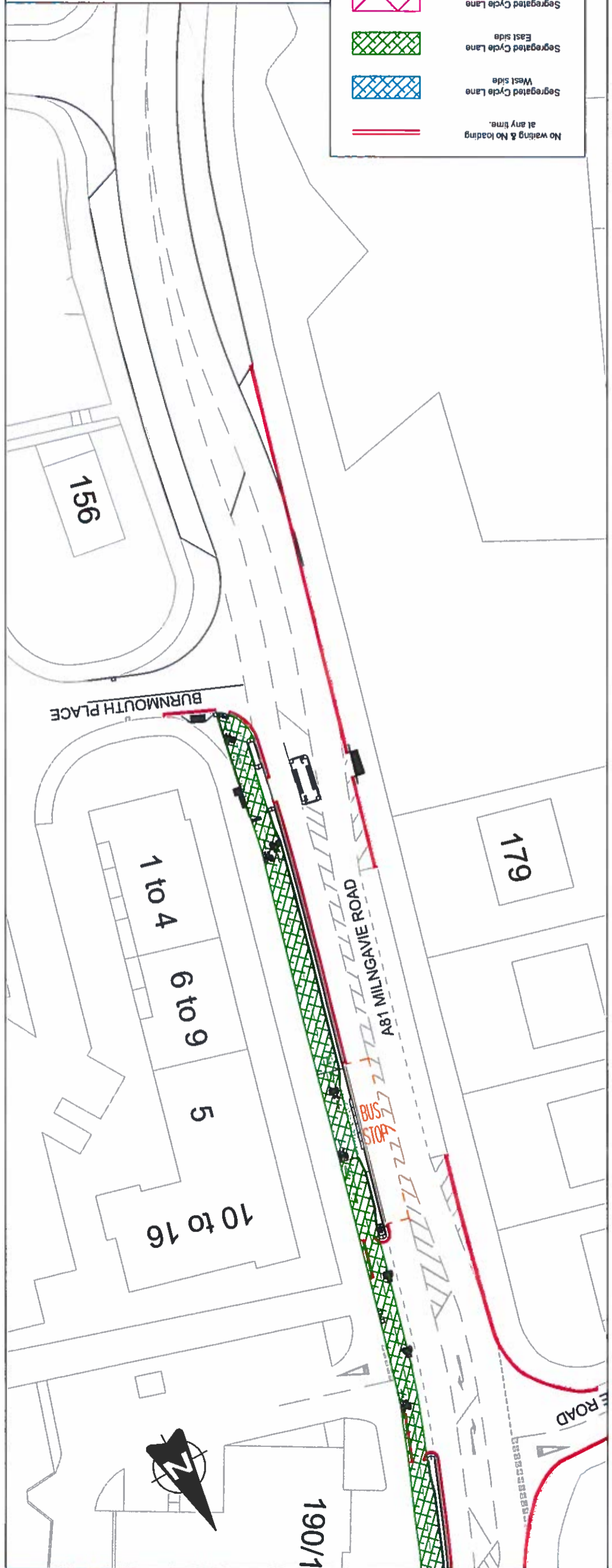

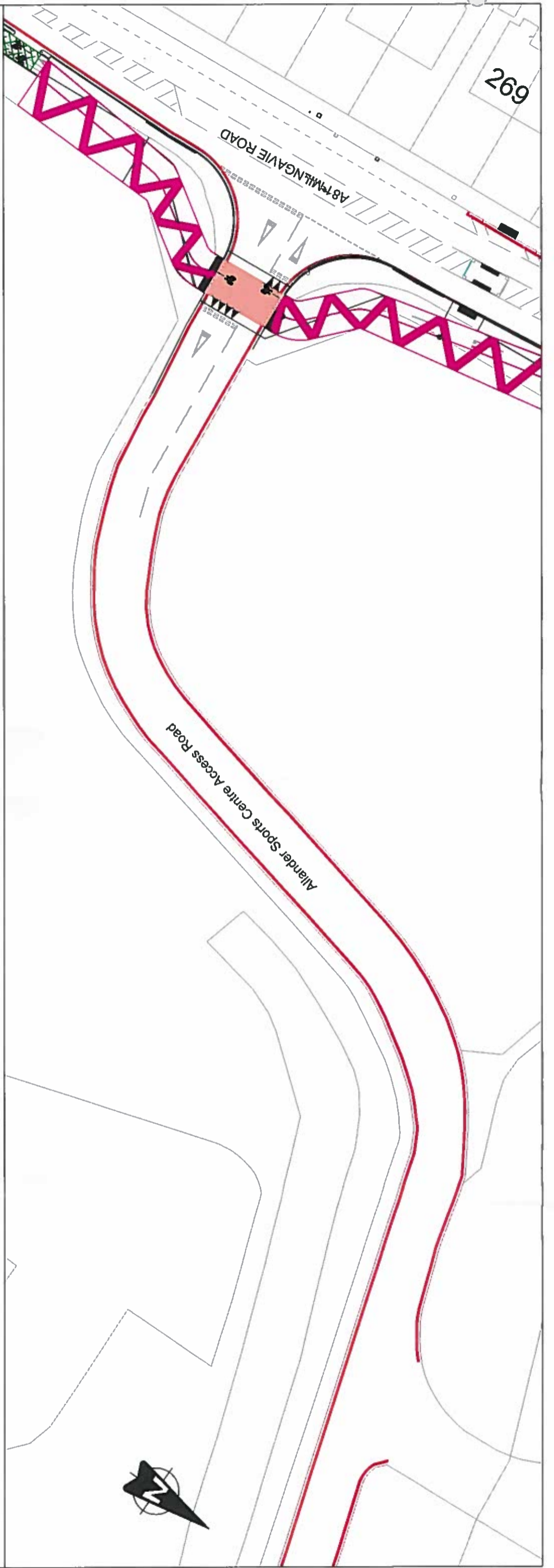
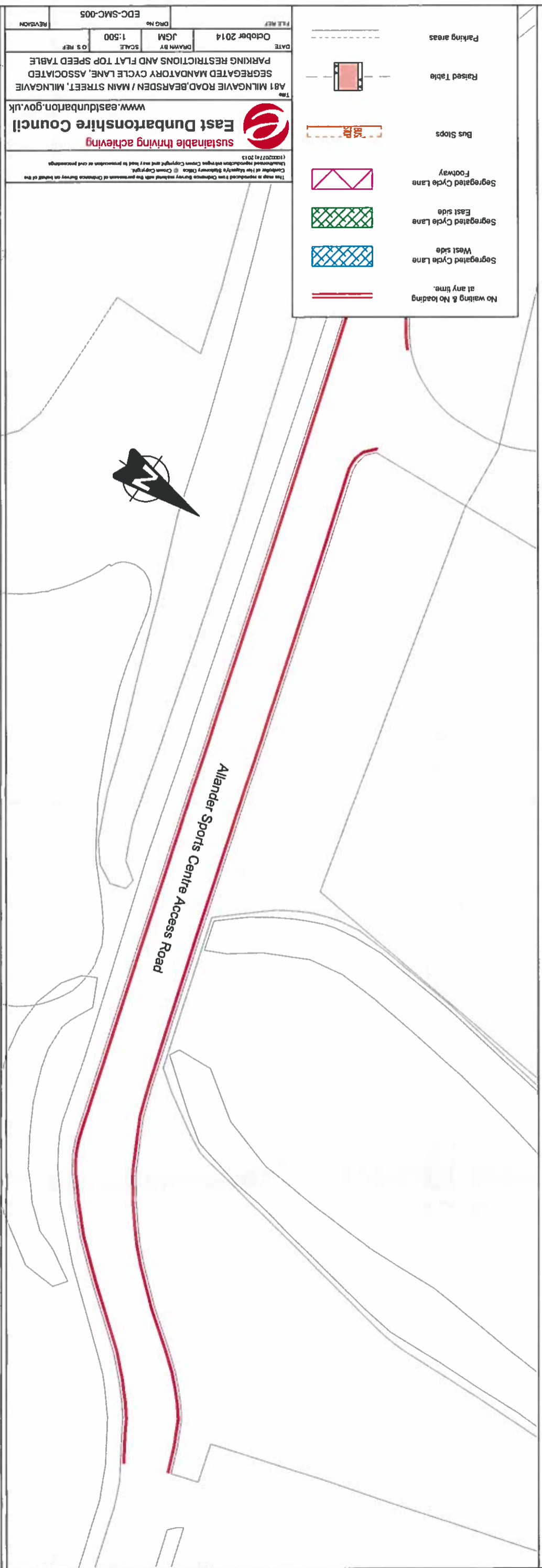

FILE REF: EDC-SMC-005
 DATE: October 2014
 DRAWN BY: JGM
 SCALE: 1:500
 O.S. REF: [blank]

East Dunbartonshire Council
 sustainable thriving achieving
 www.eastdunbarton.gov.uk

A81 MILNGAVIE ROAD, BEARSDEN / MAIN STREET, MILNGAVIE
 SEGREGATED MANDATORY CYCLE LANE, ASSOCIATED
 PARKING RESTRICTIONS AND FLAT TOP SPEED TABLE

This map is reproduced from Ordnance Survey material with the permission of Ordnance Survey on behalf of the
 Controller of Her Majesty's Stationery Office. © Crown Copyright.
 Ordnance Survey is a registered trademark of Ordnance Survey.
 (10002774) 2013

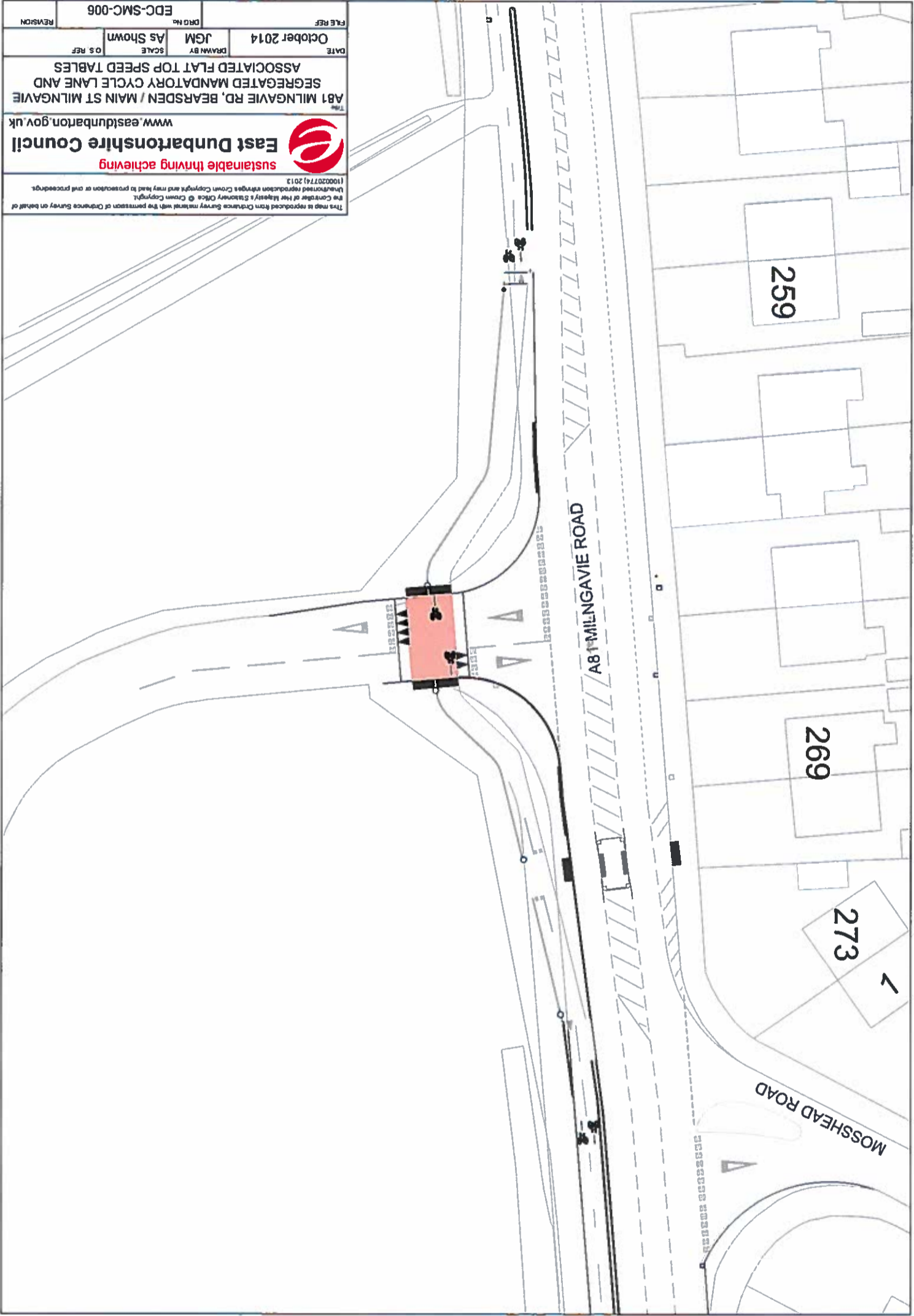

<small>This map is reproduced from Ordnance Survey material with the permission of Ordnance Survey on behalf of the Controller of Her Majesty's Stationery Office. © Crown Copyright. Unauthorised reproduction infringes Crown Copyright and may lead to prosecution or civil proceedings. 100020774/2013</small>	
sustainable thriving achieving	
East Dunbartonshire Council www.eastdunbarton.gov.uk	
A81 MILNGAVIE RD, BEARDSDEN / MAIN ST MILNGAVIE SEGREGATED MANDATORY CYCLE LANE AND ASSOCIATED FLAT TOP SPEED TABLES	
DATE	October 2014
DRAWN BY	JGM
SCALE	As Shown
O.S. REF.	
DRG No.	EDC-SMC-006
REVISION	

FILE REF		DRAWN BY		DATE	
EDC-SMC-007		JGM		October 2014	
OS REF		SCALE		PROJECT	
		1:525		A81 MILNGAVIE ROAD, BEARSDEN / MAIN STREET, MILNGAVIE ALLANDER SPORTS CENTRE ACCESS ROAD SHARED SURFACE	
 East Dunbartonshire Council www.eastdunbarton.gov.uk sustainable thriving achieving					
<small>This map is reproduced from Ordnance Survey survey material with the permission of Ordnance Survey on behalf of the Ordnance Survey. All rights reserved. Ordnance Survey Licence No: 100020741 2013 Ordnance Survey is a registered trademark of Ordnance Survey. All rights reserved.</small>					
Key  Combined Footway & Cycle Lane					

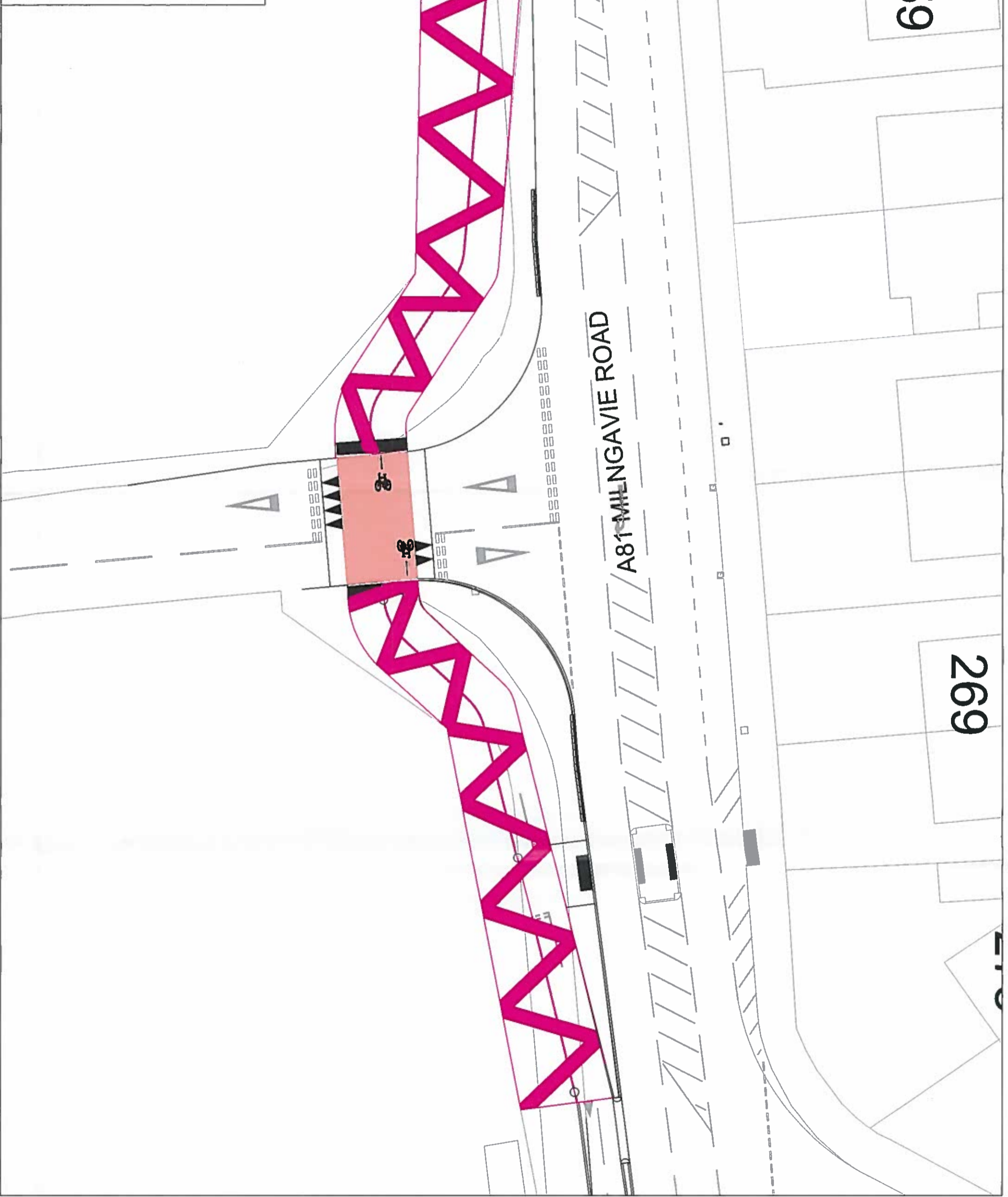

...

