

THE EAST DUNBARTONSHIRE COUNCIL

(LENZIE)

(WAITING RESTRICTIONS)

ORDER 2019

On 11 November 2019 the East Dunbartonshire Council made an Order under the Road Traffic Regulations Act 1984 which comes into operation on Monday, 6 January 2020.

The proposed Order was advertised in the Kirkintilloch Herald which was published on 19 March 2019 and the effect of the order would be the introduction of waiting restrictions on various lengths of roads that are located in the vicinity of Lenzie Station and surrounding streets.

A copy of the Order and plans detailing the lengths of road affected may be examined during normal office hours and without payment of fee at the offices of:-

1. Traffic and Transport, Broomhill Industrial Estate, Kilsyth Road, Kirkintilloch, G66 1TF (Telephone Enquiries to: 0300-123-4510);
2. Legal Services, 12 Strathkelvin Place, Kirkintilloch, G66 1TJ (Telephone Enquiries to: 0300-123-4510);

and also at the following Libraries during normal opening hours

3. William Patrick Library, 2-4 West High Street, Kirkintilloch, G66 1AD
4. Lenzie Library, 13/15 Alexander Avenue, Lenzie, G66 5BG

Any person wishing to question the validity of the Order or any provision therein on grounds that the Order is not within the powers conferred by the Road Traffic Regulations Act 1984, or on the grounds that any requirement of that Act or of any relevant Regulation made thereunder has not been complied with in relation to the Order may, within 6 weeks from 11 November 2019 make application to the Court of Session for this purpose.

Karen Donnelly
Chief Solicitor & Monitoring Officer
East Dunbartonshire Council Headquarters
12 Strathkelvin Place
Kirkintilloch.
G66 ITJ

THE EAST DUNBARTONSHIRE COUNCIL

(LENZIE)

(WAITING RESTRICTIONS) ORDER 2019

The East Dunbartonshire Council in exercise of the powers conferred on them by sections 1(1), 2(1) to (3) and Part IV of Schedule 9 of the Road Traffic Regulation Act 1984 (“the Act”) and of all other enabling powers and after consultation with the Chief Constable of Police Service of Scotland in accordance with Part III of Schedule 9 to the Act hereby make the following Order.

1. This Order may be cited as “The East Dunbartonshire Council (Lenzie) (Waiting Restrictions) Order 2019 and shall come into operation on 6 January 2020.

2. In this Order the following expressions have the meanings hereby assigned to them:-

“**vehicle**” unless the context otherwise requires, means a vehicle of any description and includes a machine or implement of any kind drawn or propelled along roads whether or not by mechanical power;

“**taxi**” has the same meaning as in Section 23(1) of the Civic Government (Scotland) Act 1982;

“**disabled person’s badge**” has the same meaning as in the Local Authorities Traffic Orders (Exemptions for Disabled Persons) (Scotland) Regulations 2002;

“**local authority**” means a Council constituted by Section 2 of the Local Government etc (Scotland) Act 1994;

“**Council**” means the East Dunbartonshire Council incorporated under the Local Government etc (Scotland) Act 1994;

3. Save as provided in Articles 9, 10 and 11 of this Order no person shall, except upon the direction or with the permission of a traffic warden or a police constable in uniform, cause or permit any vehicle to wait at any time in the lengths of roads specified in Schedule 1 to this Order.

4. Save as provided in Articles 9, 10 and 11 of this Order no person shall, except upon the direction or with the permission of a traffic warden or a police constable in uniform, cause or permit any vehicle to wait between the hours of 7:00 am to 6:00 pm Monday to Friday inclusive and 7:00 am to 1:00 pm, on Saturdays in the lengths of roads specified in Schedule 2 to this Order.

5. Save as provided in Articles 9, 10 and 11 of this Order no person shall, except upon the direction or with the permission of a traffic warden or a police constable in uniform, cause or permit any vehicle to wait between the hours of

10:00 am to Noon Monday to Friday inclusive in the lengths of roads specified in Schedule 3 to this Order

6. Save as provided in Articles 9, 10 and 11 of this Order no person shall, except upon the direction or with the permission of a traffic warden or a police constable in uniform, cause or permit any vehicle to wait between the hours of 5:00 am to 10:00 am, Monday to Saturday inclusive in the lengths of roads specified in Schedule 4 to this Order
7. Save as provided in Articles 9, 10 and 12 of this Order no person shall, except upon the direction or with the permission of a traffic warden or a police constable in uniform, cause or permit any vehicle to wait between the hours of 10:00 am and 6:00 pm, Monday to Saturday inclusive in the length of road specified in Schedule 5 to this Order:-
 - (a) for a longer period than 2 hours; or
 - (b) if a period of less than 1 hours has elapsed since the last period of waiting of the vehicle in any of the said lengths of roads.
8. Save as provided in Articles 9, 10 and 12 of this Order no person shall, except upon the direction or with the permission of a traffic warden or a police constable in uniform, cause or permit any vehicle to wait between the hours of 7:00 am and 6:00 pm, Monday to Saturday inclusive in the lengths of road specified in Schedule 6 to this Order:-
 - (a) for a longer period than 2 hours; or
 - (b) if a period of less than 1 hours has elapsed since the last period of waiting of the vehicle in any of the said lengths of roads.
9. Nothing in Article 3, 4, 5, 6, 7 and 8 of this Order shall :-
 - (a) prevent any person from causing or permitting a vehicle to wait in any of the lengths of road referred to in that Article:-
 - (i) for so long as may be necessary to enable a person to board or alight from the vehicle or to load thereon or unload therefrom their personal luggage;
 - (ii) for so long as may be necessary to enable the vehicle, if it cannot conveniently be used for such purpose in any other road, to be used in connection with any building operation or demolition, the removal of any obstruction to traffic, the maintenance, improvement or reconstruction of any of the lengths of roads so referred to, or the laying, erection, alteration or repair in or near to any of the said lengths of roads, of any sewer or of any main, pipe or apparatus for the supply of gas, water or electricity, or of any telecommunications apparatus as defined in the Telecommunications Act 1984;

- (iii) to enable the vehicle, if it cannot conveniently be used for such purpose in any other road, to be used in pursuance of statutory powers and duties and in particular, but without prejudice to the generality of the foregoing, to enable the vehicle to be used in connection with police, fire brigade and ambulance purposes;
 - (iv) if the vehicle is waiting owing to the driver being prevented from proceeding by circumstances beyond their control or to such waiting being necessary in order to avoid an accident;
 - (v) if the vehicle is waiting in any of the lengths of roads while postal packets addressed to premises adjacent thereto are being unloaded from the vehicle or having been unloaded therefrom are being delivered or while postal packets are being collected from premises or posting boxes adjacent thereto;
 - (vi) for the purpose of loading or unloading the vehicle while the vehicle is standing at the kerb and is in actual use in connection with the removal of furniture from one office or dwelling house to another or the removal of furniture from such premises to a depository or to such premises from a depository;
 - (vii) to enable the vehicle to be used in connection with wedding and funeral operations.
- (b) apply to a licenced taxi waiting in a taxi stance during any period for which that stance has been designated by the Council under the Civic Government (Scotland) Act 1982.
10. Nothing in Articles 3, 4, 5, 6, 7 and 8 shall apply to any vehicle which is not causing an obstruction and which displays a disabled person's badge.
11. Nothing in Articles 3, 4, 5 and 6 of this Order shall prevent any person from causing or permitting a vehicle to wait in the lengths of roads referred to in that Article
- (a) for so long as may be necessary for the purpose of delivering or collecting goods or merchandise or loading or unloading the vehicle at premises adjoining that road provided that no vehicle engaged in delivering or collecting goods or merchandise or being loaded or unloaded shall wait for a longer period than 30 minutes in the same place and no such vehicle shall wait for a longer period than 10 minutes in the same place without goods being loaded onto or unloaded from the vehicle;
 - (b) notwithstanding anything in paragraph (a) of this Article the driver waiting for the purpose of delivering or collecting goods or merchandise or loading or unloading the vehicle shall move the same on the instruction of a police constable in uniform whenever such

moving may be reasonably necessary for the purpose of preventing an obstruction.

12. Nothing in Articles 7 and 8 of this Order shall prevent any person from causing or permitting a vehicle to wait in the length of road referred to in that Article
- (a) for so long as may be necessary for the purpose of delivering or collecting goods or merchandise or loading or unloading the vehicle at premises adjoining that road provided that no vehicle engaged in delivering or collecting goods or merchandise or being loaded or unloaded shall wait for a longer period than 2 hours in the same place and no such vehicle shall wait for a longer period than 10 minutes in the same place without goods being loaded onto or unloaded from the vehicle;
 - (b) notwithstanding anything in paragraph (a) of this Article the driver waiting for the purpose of delivering or collecting goods or merchandise or loading or unloading the vehicle shall move the same on the instruction of a police constable in uniform whenever such moving may be reasonably necessary for the purpose of preventing an obstruction.
13. The Orders specified in Schedule 7 to this Order shall have effect subject to the amendments specified in that Schedule 7.

Sealed with the Common Seal of the Council and subscribed for them and on their behalf by Karen M Donnelly, Chief Solicitor and Monitoring Officer at Kirkintilloch on the Eleventh day of November in the year Two thousand and nineteen.

.....
KAREN M. DONNELLY
CHIEF SOLICITOR & MONITORING OFFICER

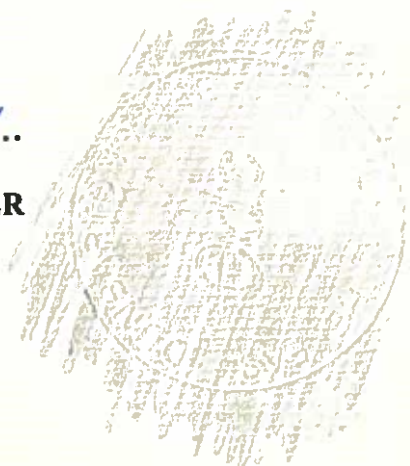

SCHEDULE 1

NO WAITING AT ANY TIME.

<u>Lengths of Road in East Dunbartonshire within Lenzie</u>	<u>Side of Road to which Restriction Applies</u>
<u>Albert Road</u>	
1. From the extended west kerbline of Victoria Road south-westwards for a distance of 15 metres.	Both
<u>Alexandra Avenue/Road</u>	
1. From the extended northwest kerbline of Heriot Road north-westwards then north-eastwards to a point 80 metres southeast of the extended southwest kerbline of Victoria Road.	Northeast & Southeast
2. From the extended southwest kerbline of Victoria Road south-westwards for a distance of 10 metres.	Southeast
3. From the extended northeast kerbline of Victoria Road north-eastwards for the length of the road.	Southeast
4. From a point 40 metres northeast of the extended northeast kerbline of Victoria Road north-eastwards for a distance of 10 metres.	Northwest
5. From a point 40 metres southwest of the extended southwest kerbline of Victoria Road south-westwards for a distance of 5 metres.	Northwest
6. From a point 69 metres southwest of the extended southwest kerbline of Victoria Road south-westwards then south-eastwards to a point 56 metres northwest of the extended northwest kerbline of Alexandra Park.	Northwest & Southwest
7. From a point 15 metres northwest of the extended northwest kerbline of Alexandra park south-eastwards to a point 15 metres southeast of the extended southeast kerbline of Alexandra Park.	Southwest
8. From the extended northwest kerbline of Herriot Road north-westwards for a distance of 15 metres.	Southwest
<u>Alexandra Gardens</u>	
1. From the extended northeast kerbline of Alexandra Road north-eastwards for a distance of 15 metres.	Both
<u>Alexandra Park</u>	
1. From the extended southwest kerbline of Alexandra Road south-westwards for a distance of 15 metres.	Both
<u>Beechmount Road</u>	
1. From the extended southwest kerbline of Auchinloch Road westwards to a point 15 metres southwest of the extended west kerbline of Glenbank Road.	South
2. From a point 15 metres east of the extended east kerbline of Regent Square westwards to a point 15 metres west of the extended west kerbline of Regent Square.	South
3. From the extended northeast kerbline of Victoria Road north-eastwards for a distance of 15 metres.	Both
4. From a point 38 metres southwest of the extended southwest kerbline of Glenbank Avenue north-eastwards to a point 5 metres northeast of the extended northeast kerbline of Glenbank Avenue.	North

SCHEDULE 1

CONTINUED

NO WAITING AT ANY TIME.

Lengths of Road in East Dunbartonshire within Lenzie

Side of Road to which
Restriction Applies

Beechmount Road (continued)

5. From a point 35 metres northeast of the extended northeast kerbline of Glenbank Avenue eastwards to the extended southwest kerbline of Auchinloch Road. North

Fern Avenue

1. From the extended southeast kerbline of Kirkintilloch Road south-westwards for a distance of 70 metres. Both

Garngaber Avenue

1. From the extended east kerbline of Kirkintilloch Road eastwards for a distance of 20 metres. Both

Glenbank Road

1. From the extended south kerbline of Beechmount Road southwards for a distance of 10 metre. Both
2. From a point 15 metres north of the extended north kerbline of Regent Square southwards to a point 15 metres south of the extended south kerbline of Regent Square. Both
3. From the extended northwest kerbline of Glenhead road northwards for a distance of 10 metres. Both

Glenhead Road

1. From the extended west kerbline of Auchinloch Road south-westwards for a distance of 53 metres. Both
2. From a point 15 metres northeast of the extended east kerbline of Glenbank Road south-westwards to a point 15 metres southwest of the extended west kerbline of Glenbank Road. Both
3. From the extended west kerbline of Victoria Road north-eastwards for a distance of 15 metres. Both

Heath Avenue

1. From the extended southwest kerbline of Kirkintilloch Road south-westwards for a distance of 24 metres. Both
2. From a point 143 metres southwest of the extended southwest kerbline of Kirkintilloch Road south-westwards for a distance of 111 metres including the turning head. Southeast
3. From a point 229 metres southwest of the extended southwest kerbline of Kirkintilloch Road south-westwards to the extent of the road. Northwest

Heriot Road

1. From the extended west kerbline of Victoria Road south-westwards for a distance of 15 metres. Both
2. From a point 15 metres northeast of the extended northeast kerbline of Alexandra Road south-westwards to a point 15 metres southwest of the extended southwest kerbline of Alexandra Road. Both

SCHEDULE 1

CONTINUED

NO WAITING AT ANY TIME.

Lengths of Road in East Dunbartonshire within Lenzie

Side of Road to which
Restriction Applies

Kirkintilloch Road

- | | |
|---|-----------|
| 1. From a point 15 metres northwest of the extended northwest kerbline of Moncrieff Avenue south-eastwards to a point 80 metres south of the extended southeast kerbline of Garngaber Avenue. | Northeast |
| 2. From a point 15 metres northwest of the extended northwest kerbline of Fern Avenue south-eastwards to a point 37 metres southeast of the extended southeast kerbline of Heath Avenue. | Southwest |
| 3. From a point 49 metres southeast of the extended southeast kerbline of Heath Avenue south-eastwards for a distance of 33 metres. | Southwest |

Millersneuk Drive

- | | |
|--|------|
| 1. From the extended northeast kerbline of Millersneuk Road north-eastwards and eastwards for a distance of 80 metres. | Both |
|--|------|

Millersneuk road

- | | |
|---|------|
| 1. From the extended east kerbline of Auchinloch Road eastwards to a point 15 metres southeast of the extended southeast kerbline of Millersneuk Drive. | Both |
|---|------|

Moncrieff Avenue

- | | |
|--|------|
| 1. From the extended northeast kerbline of Kirkintilloch Road north-eastwards for a distance of 15 metres. | Both |
|--|------|

Regent Square

- | | |
|--|--------------|
| 1. From the extended west kerbline of Glenbank Road westwards for a distance of 10 metres. | Both |
| 2. From the extended south kerbline of Beechmount Road southwards for a distance of 10 metres. | East |
| 3. From a point 65 metres south of the extended south kerbline of Beechmount Road southwards then eastwards for a distance of 10 metres. | East & North |
| 4. From the extended south kerbline of Beechmount Road southwards for a distance of 10 metres. | West |
| 5. From a point 65 metre south of the extended south kerbline of Beechmount Road southwards then eastwards for a distance of 20 metres. | West & South |

Victoria Road

- | | |
|--|------|
| 1. From the extended south kerbline of Alexandra Avenue southwards for a distance of 22 metres. | East |
| 2. From the extended south kerbline of Alexandra Avenue southwards for a distance of 10 metres. | West |
| 3. From a point 15 metres north of the extended north kerbline of Beechmount Road southwards to a point 15 metres south of the extended south kerbline of Beechmount Road. | Both |

SCHEDULE 1

CONTINUED

NO WAITING AT ANY TIME.

Lengths of Road in East Dunbartonshire within Lenzie

Side of Road to which
Restriction Applies

- | | |
|--|------|
| 4. From a point 15 metres north of the extended northwest Kerbline of Glenhead Road southwards to a point 15 metres south of the extended southeast kerbline of Heriot Road. | Both |
| 5. From a point 15 metres north of the extended northwest kerbline of Albert Road southwards to a point 15 metres south of the extended south kerbline of Heriot Road. | Both |



KAREN M DONNELLY
CHIEF SOLICITOR & MONITORING OFFICER

SCHEDULE 2

NO WAITING, 7AM TO 6PM, MONDAY TO FRIDAY, 7AM TO 1PM SATURDAY.

Lengths of Road in East Dunbartonshire within Lenzie

Side of Road to which
Restriction Applies

Garrgaber Avenue

- | | |
|--|-------|
| 1. From a point 20 metres east of the extended east kerbline of Kirkintilloch Road eastwards to a point 20 metres east of the extended northeast kerbline of Larkfield Road. | North |
| 2. From a point 57 metres east of the extended east kerbline of Kirkintilloch Road eastwards to a point 20 metres east of the extended northeast kerbline of Larkfield Road. | South |

Heath Avenue

- | | |
|--|-----------|
| 1. From a point 24 metres southwest of the extended southwest kerbline of Kirkintilloch Road south-westwards for a distance of 205 metres. | Northwest |
| 2. From a point 41 metres southwest of the extended southwest kerbline of Kirkintilloch Road south-westwards for a distance of 11 metres. | Southeast |
| 3. From a point 63 metres southwest of the extended southwest kerbline of Kirkintilloch Road south-westwards for a distance of 9 metres. | Southeast |
| 4. From a point 101 metres southwest of the extended southwest kerbline of Kirkintilloch Road south-westwards for a distance of 13 metres. | Southeast |

.....
KAREN M DONNELLY
CHIEF SOLICITOR & MONITORING OFFICER

SCHEDULE 3

NO WAITING, 10AM – NOON, MONDAYS TO FRIDAYS.

Lengths of Road in East Dunbartonshire within Lenzie

Side of Road to which
Restriction Applies

Alexandra Gardens

1. From a point 15 metres northeast of the extended northeast kerblineline of Alexandra Road for the entire length of the road.

Both

Alexandra Park

1. From a point 15 metres southwest of the extended southwest kerblineline of Alexandra Road for the entire length of the road.

Both



.....
KAREN M DONNELLY
CHIEF SOLICITOR & MONITORING OFFICER

SCHEDULE 4

NO WAITING 5AM TO 10AM, MONDAYS TO SATURDAYS.

Lengths of Road in East Dunbartonshire within Lenzie

Side of Road to which
Restriction Applies

Kirkintilloch Road

1. From a point 33 metres south east of the extended southeast kerbline
of Heath Avenue south-eastwards for a distance of 16 metres.

Southwest



.....
KAREN M DONNELLY
CHIEF SOLICITOR & MONITORING OFFICER

SCHEDULE 5

WAITING LIMITED TO 2 HOURS, 10AM – 6PM, MONDAYS TO SATURDAYS.
NO RETURN WITHIN 1 HOUR.

Lengths of Road in East Dunbartonshire within Lenzie

Side of Road to which
Restriction Applies

Kirkintilloch Road

1. From a point 33 metres south east of the extended southeast kerbline
of Heath Avenue south-eastwards for a distance of 16 metres.

Southwest

.....
KAREN M DONNELLY
CHIEF SOLICITOR & MONITORING OFFICER

SCHEDULE 6

WAITING LIMITED TO 2 HOURS, 7AM – 6PM, MONDAYS TO SATURDAYS.
NO RETURN WITHIN 1 HOUR.

Lengths of Road in East Dunbartonshire within Lenzie

Side of Road to which
Restriction Applies

Garngaber Avenue

1. From a point 20 metres east of the extended east kerbline of Kirkintilloch Road eastwards for a distance of 37 metres.

South

Heath Avenue

1. From a point 24 metres southwest of the extended southwest kerbline of Kirkintilloch Road south-westwards for a distance of 17 metres.
2. From a point 52metres southwest of the extended southwest kerbline of Kirkintilloch Road south-westwards for a distance of 11 metres.
3. From a point 72 metres southwest of the extended southwest kerbline of Kirkintilloch Road south-westwards for a distance of 29 metres.
4. From a point 114 metres southwest of the extended southwest kerbline of Kirkintilloch Road south-westwards for a distance of 29 metres.

Southeast

Southeast

Southeast

Southeast

.....
KAREN M DONNELLY
CHIEF SOLICITOR & MONITORING OFFICER

SCHEDULE 7
ORDERS TO BE AMENDED

Name of Order

Extent of Amendment

The East Dunbartonshire Council
(Lenzie), (No Stopping, Waiting
and Loading Restrictions
Consolidation)
Order 2013

Delete all reference to Schedules 2 & 6.



.....
KAREN M DONNELLY
CHIEF SOLICITOR & MONITORING OFFICER

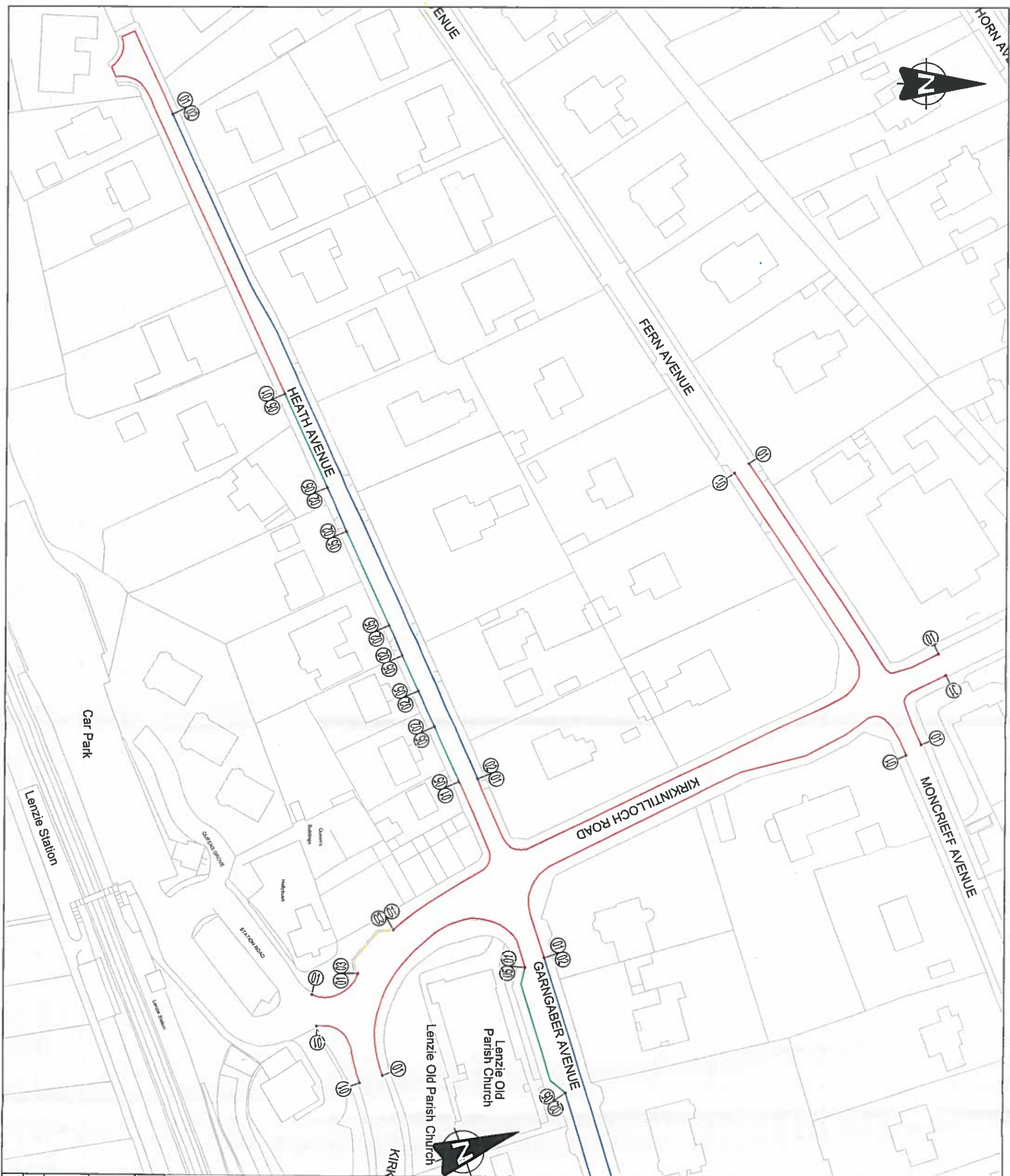

- ⓪ No waiting at any time.
- ⓫ No waiting, 7am - 6pm, Monday to Friday, 7am - 1pm, Saturdays.
- ⓬ No waiting 5am - 10am, Monday - Saturday.
- ⓭ Waiting limited to 2 hours, 10am - 6pm, Monday to Saturday, No return within 1 hour.
- ⓮ No Waiting 10am - Noon Monday to Friday
- ⓯ Waiting, 2 hours max, 7am - 6pm, Monday to Saturday, No return within 1 hour.

M. Donnelly

East Dunbartonshire Council
www.eastdunbarton.gov.uk

Lenzie			
Proposed Parking Management Restrictions			
Sheet 1 of 6			
DATE	DRAWN BY	SCALE	O.S. REF.
May 2018	JGM	1:1000	
FILE REF	DRG No.	REVISION	
	EDC-1-PM-01/18/01		

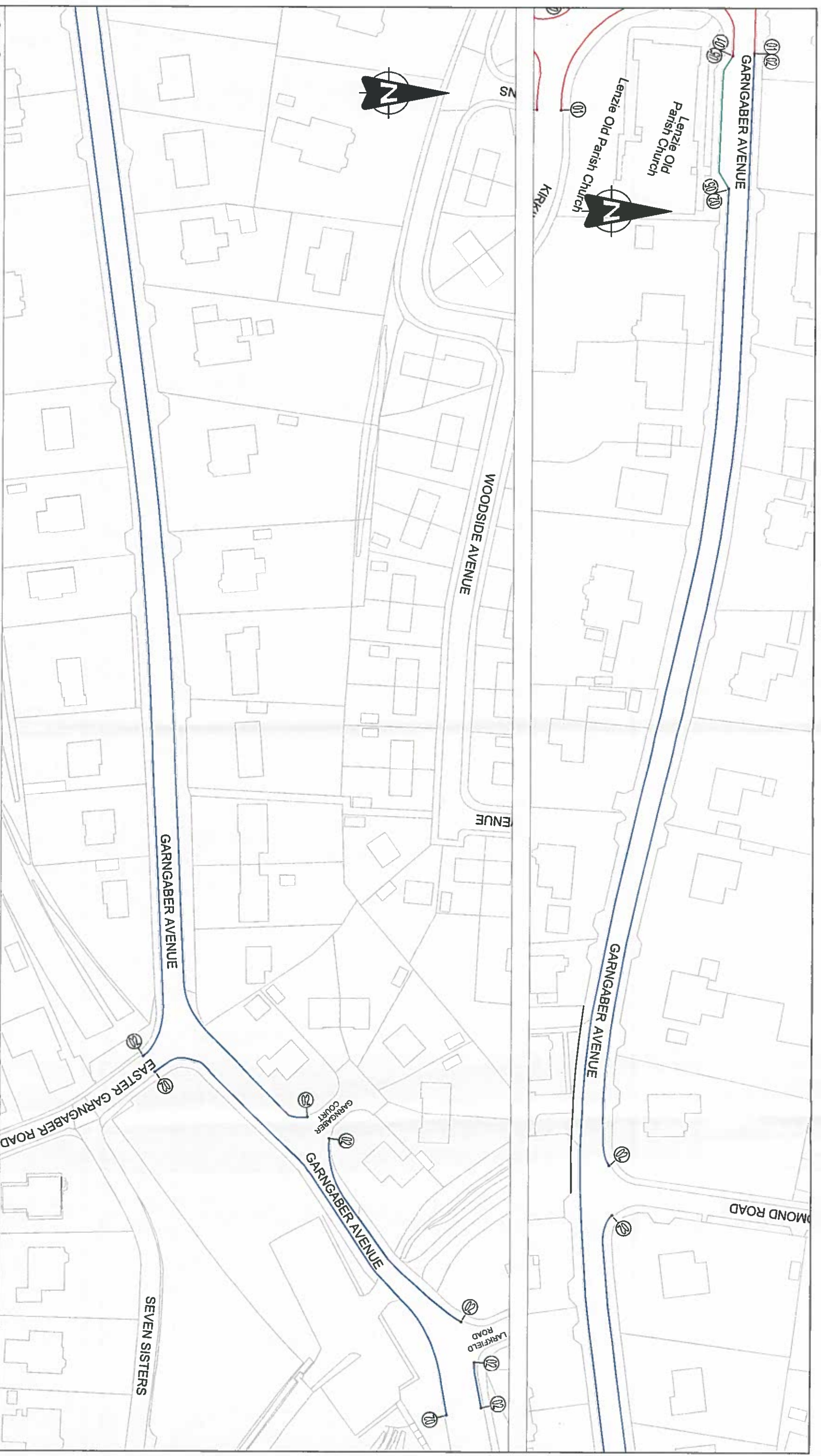

01 No waiting at any time.

02 No waiting, 7am - 6pm, Monday to Friday, 7am - 1pm, Saturdays.

03 No waiting 5am - 10am, Monday - Saturday. Waiting limited to 2 hours, 10am - 6pm, Monday to Saturday. No return within 1 hour.

04 No Waiting 10am - Noon Monday to Friday

05 Waiting limited to 2 hours, 7am - 6pm, Monday to Saturday, No return within 1 hour.

W. Denny

The map is reproduced from Ordnance Survey aerial data with the permission of Ordnance Survey on behalf of HM Government. © Crown Copyright. Unauthorised reproduction is prohibited. Ordnance Survey is not responsible for any errors or omissions, or for any consequences arising from the use of the information. (10002372) 2012

sustainable driving achieving

East Dunbartonshire Council
www.eastdunbarton.gov.uk

Lenzie			
Proposed Parking Management Restrictions			
Sheet 2 of 6			
DATE	DRAWN BY	SCALE	C.S. REF.
May 2018	JGM	1:1000	
FILE REF	PROJ No.	REVISION	
EDC-LPM-01/1802			

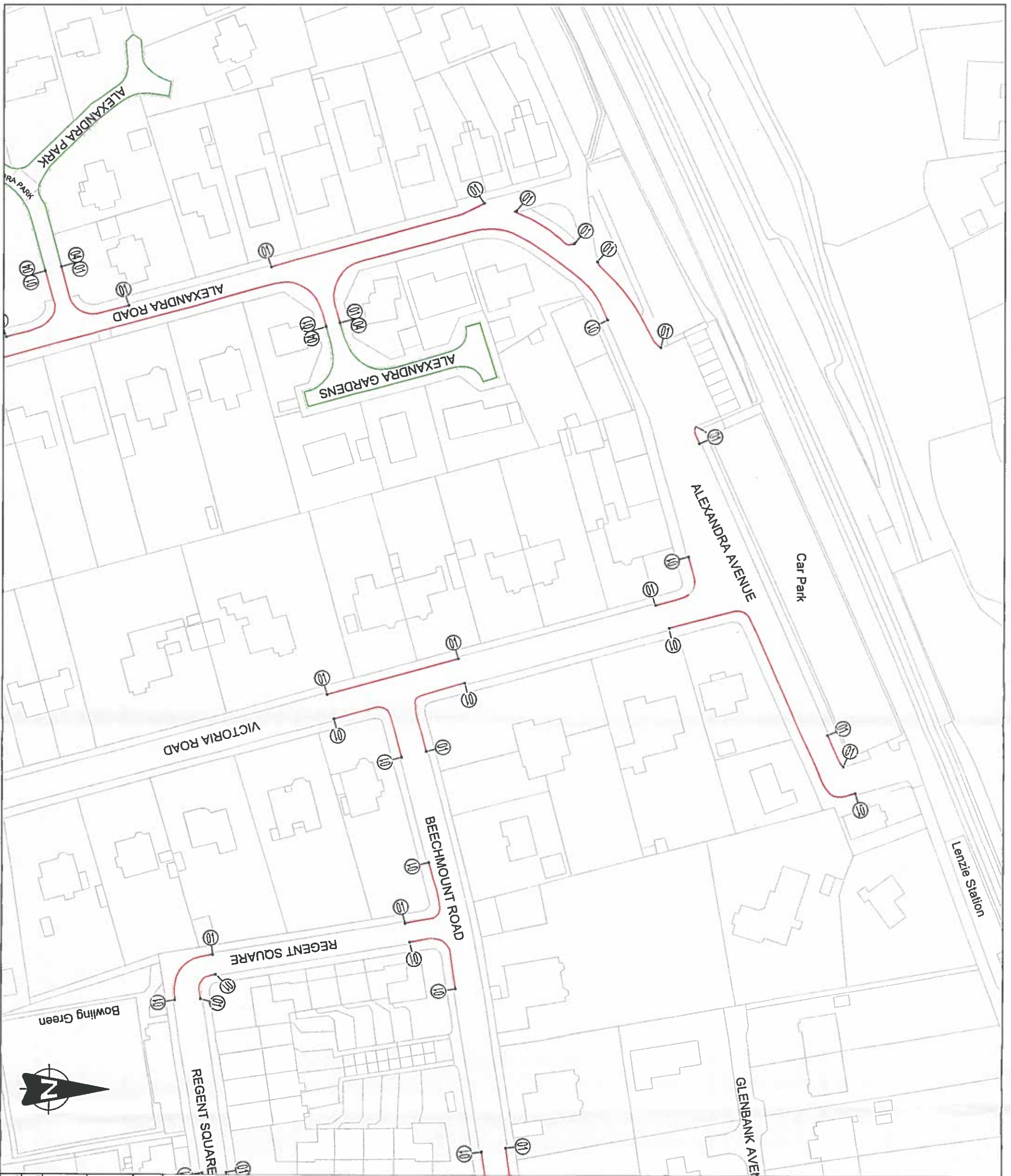

- ①① No waiting at any time.
- ①② No waiting 7am - 6pm, Monday to Friday, 7am - 1pm, Saturdays.
- ①③ No waiting 5am - 10am, Monday - Saturday. Waiting limited to 2 hours, 10am - 6pm, Monday to Saturday, No return within 1 hour
- ①④ No Waiting 10am - Noon Monday to Friday
- ①⑤ Waiting, 2 hours max, 7am -6pm, Monday to Saturday, No return within 1 hour.

Wulderney

East Dunbartonshire Council
www.eastdunbarton.gov.uk

Lenzie			
Proposed Parking Management Restrictions			
Sheet 3 of 6			
DATE	DRAWN BY	SCALE	C.D.S. REF
May 2018	JGM	1:1000	
FILE REF	DWG No.	REVISION	
	EDC-LPM-01/18/03		

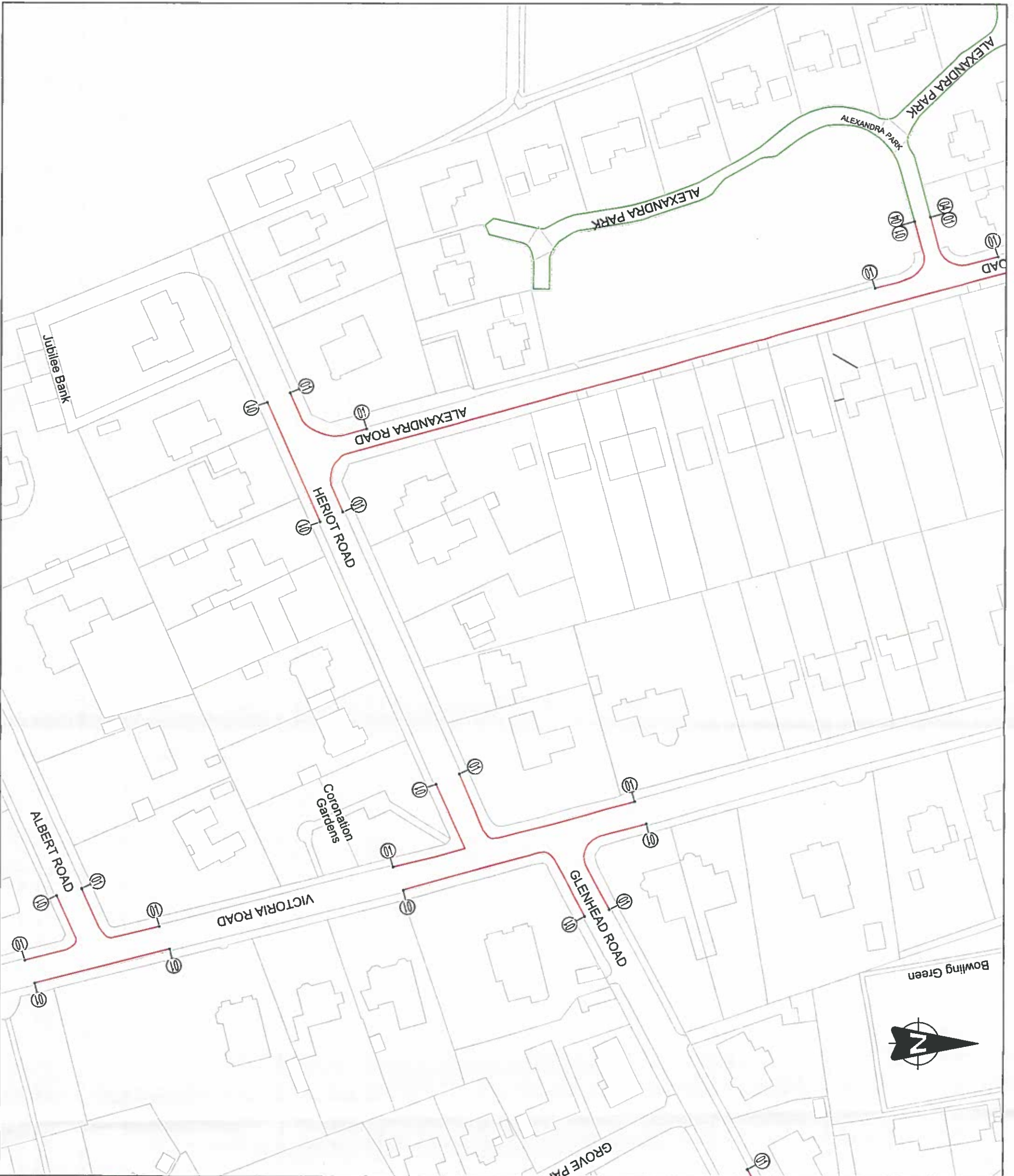

- 01 No waiting at any time.
- 02 No waiting, 7am - 6pm, Monday to Friday, 7am - 1pm, Saturdays.
- 03 No waiting 5am - 10am, Monday - Saturday.
- 04 Waiting limited to 2 hours, 10am - 6pm, Monday to Saturday, No return within 1 hour
- 05 No Waiting 10am - Noon Monday to Friday
- 06 Waiting, 2 hours max, 7am - 6pm, Monday to Saturday, No return within 1 hour.

W. W. W. W. W.

sustainable driving achieving
East Dunbartonshire Council
www.eastdunbarton.gov.uk

DATE	MAY 2018	DRAWN BY	JGM	SCALE	1:1000	C/S REF	
FILE REF	EDC-LPM-01/18/04	ORIG. No.		REVISION			

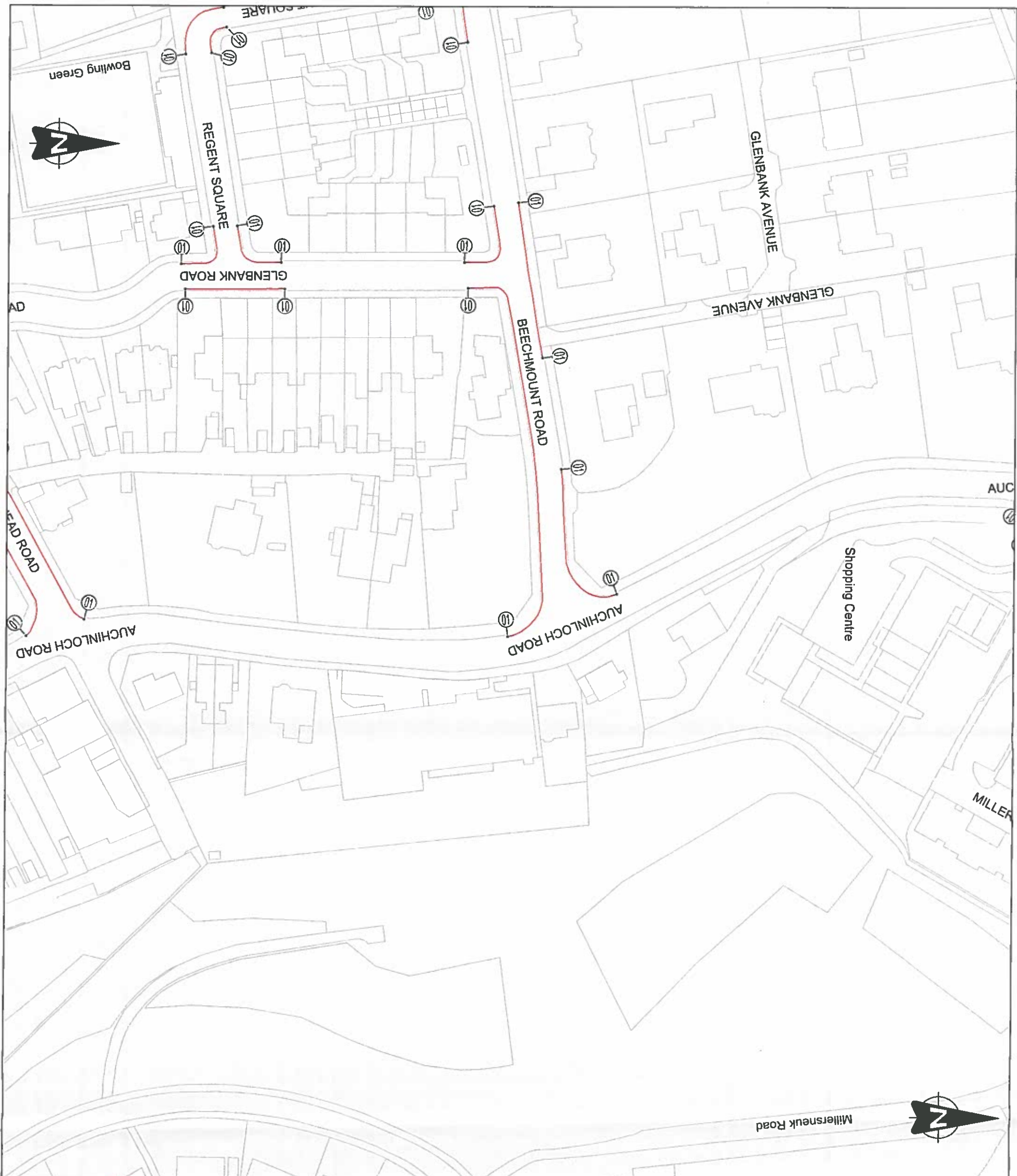

- ① No waiting at any time.
- ② No waiting, 7am - 6pm, Monday to Friday, 7am - 1pm, Saturdays.
- ③ No waiting 5am - 10am, Monday - Saturday.
- ④ Waiting limited to 2 hours, 10am - 6pm, Monday to Saturday, No return within 1 hour
- ⑤ No Waiting 10am - Noon Monday to Friday
- ⑥ Waiting, 2 hours max, 7am - 6pm, Monday to Saturday, No return within 1 hour.

www.eastdunbarton.gov.uk



Lenzie			
Proposed Parking Management Restrictions			
Sheet 5 of 6			
DATE	DRAWN BY	SCALE	O.S. REF.
May 2018	JGM	1:1000	
FILE REF	DRG No.	REVISION	
	EDC-LPM-01/18/05		

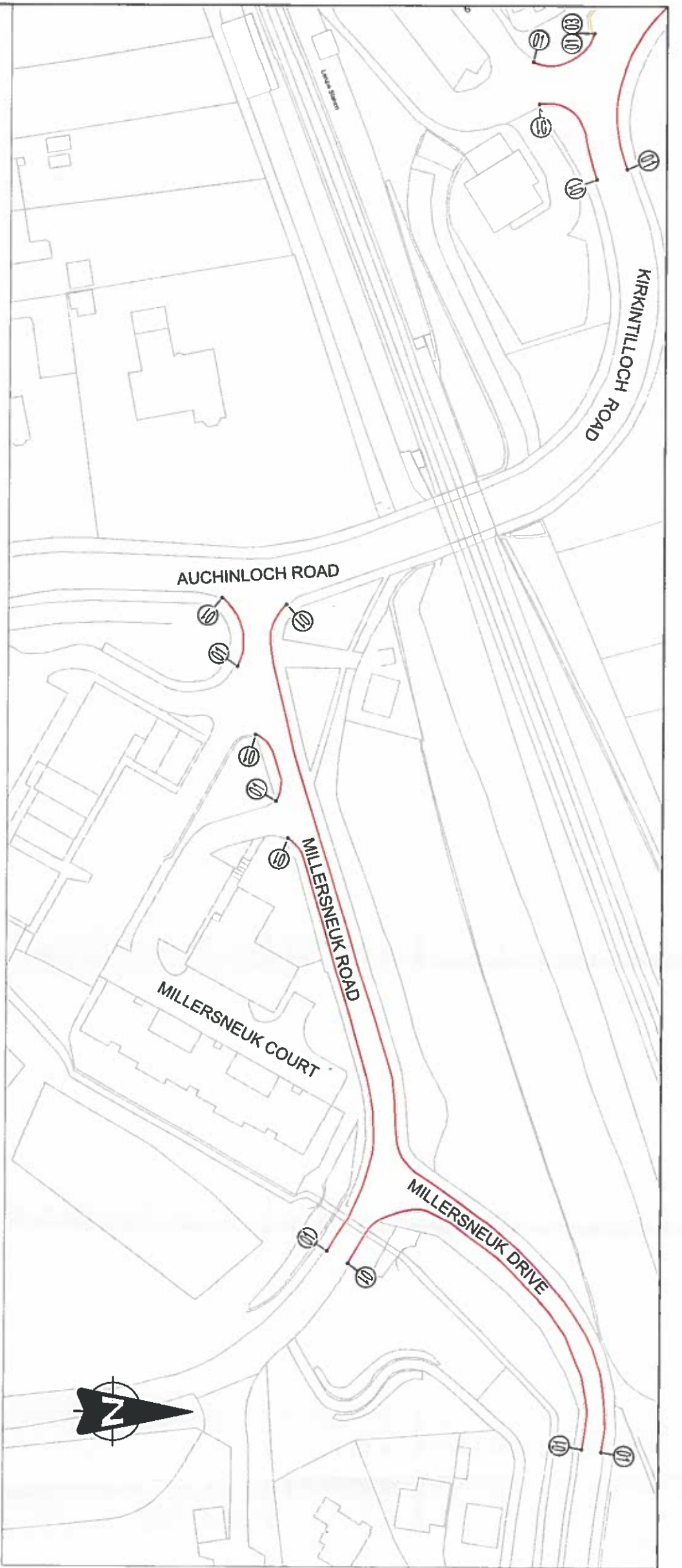

- ① No waiting at any time.
- ② No waiting 7am - 6pm, Monday to Friday, 7am - 1pm, Saturdays.
- ③ No waiting 5am - 10am, Monday - Saturday.
- ④ Waiting limited to 2 hours, 10am - 6pm, Monday to Saturday. No return within 1 hour.
- ⑤ No Waiting 10am - Noon Monday to Friday
- ⑥ Waiting, 2 hours max, 7am - 6pm, Monday to Saturday, No return within 1 hour.

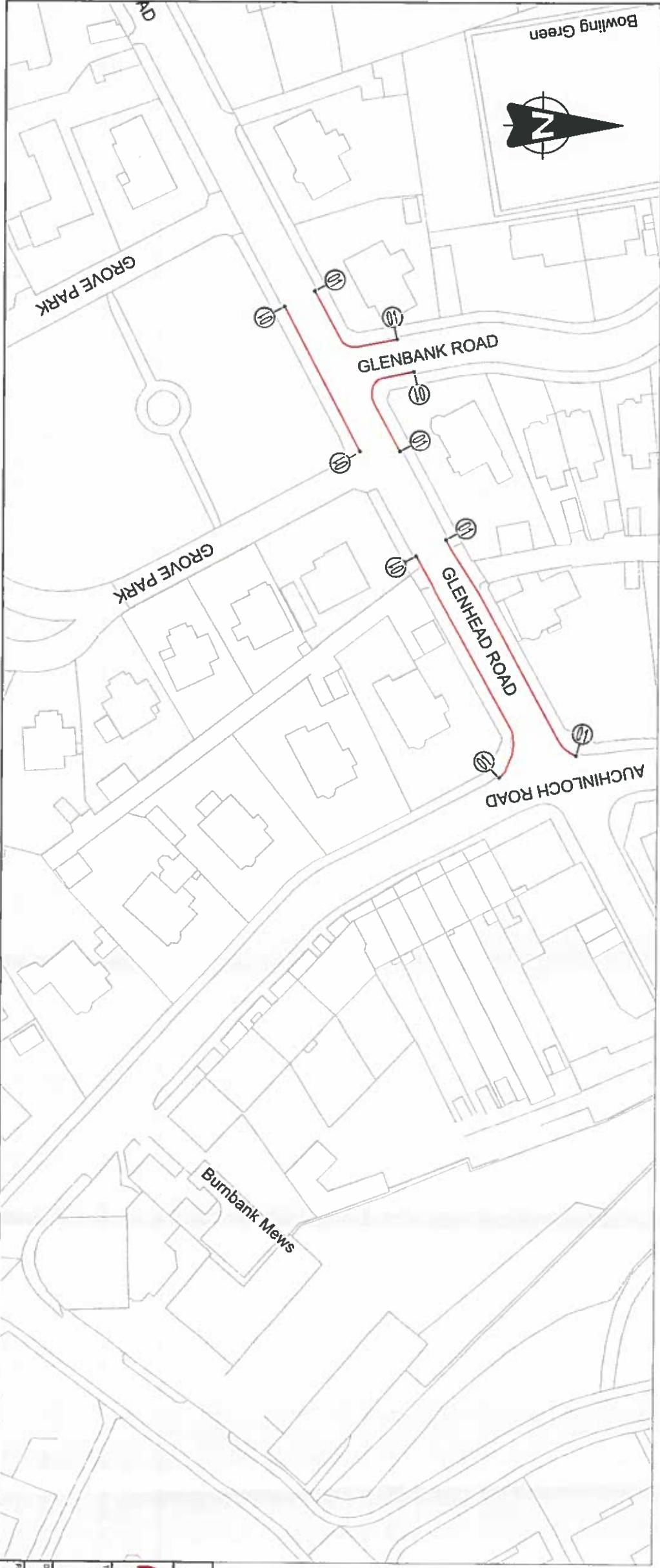

W. M. M. M.

sustainable thriving achieving

East Dunbartonshire Council
www.eastdunbarton.gov.uk

Lenzie
Proposed Parking Management Restrictions
Sheet 6 of 6

DATE	DRAWN BY	SCALE	O.S. REF.
May 2018	JGM	1:1000	
FILE REF	DRG No.	REVISION	
	EDC-1-PM-01/18/06		

This map is reproduced from Ordnance Survey records with the permission of Ordnance Survey on behalf of the Controller of Her Majesty's Stationery Office. © Crown Copyright and may be reproduced in print or electronically. (10001714) 2011