

# Newsletter

October 2020

University of Glasgow | Issue No.28

## Headlines in brief

- Welcome
- Site progress
- Working Hours
- Look ahead
- Who to contact



*Installation of the Clarice Pears Institute of Health & Wellbeing Steel Frame*

## Welcome to our October update

### Site Progress

- Works are progressing internally at the James McCune Smith Learning Hub with services, painting and decoration and flooring.
- External landscaping is progressing around the James McCune Smith on University Avenue with widened pavements and an additional crossing point.
- The Clarice Pears Institute of Health & Wellbeing structure has commenced. The erection of the steel frame will run until March 2021 with 2,500 individual pieces of steel required.
- The Research Hub envelope is ongoing alongside installation of services and internal partitions.

Built for **positive impact**

## University Avenue Traffic Management

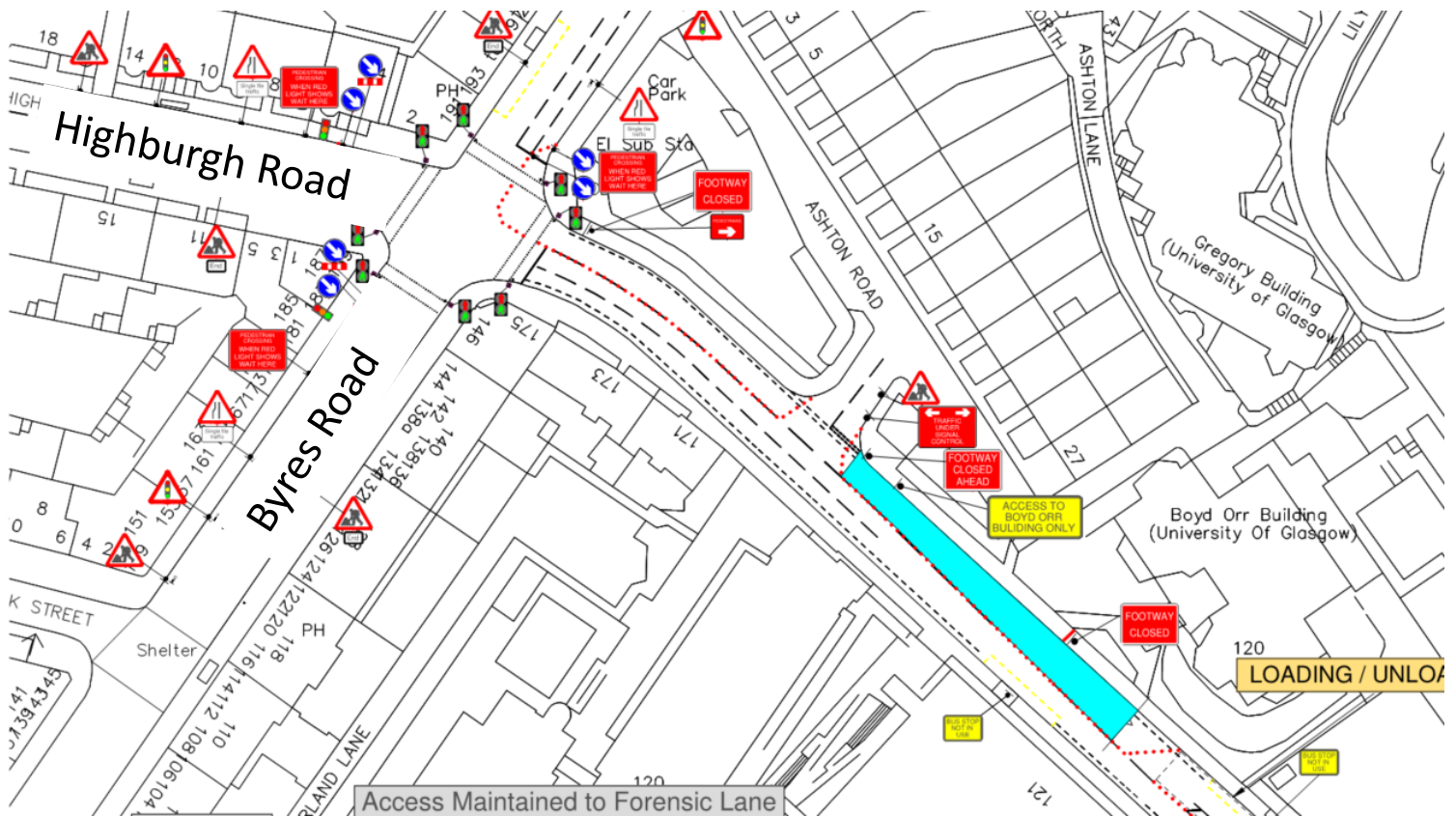

*Temporary Traffic Management system at the University Avenue/ Byres Road junction.*

- Traffic management has come into operation on University Avenue, including the junction with Byres Road and Ashton Road. Infrastructure and landscaping works are taking place on the North carriageway outside the Boyd Orr Building which should complete in December.
- During this time University Avenue will be reduced to one lane at this section, with two-way traffic flow controlled via the traffic lights.
- Access to and from Ashton Road will be maintained throughout with a traffic signal to ensure safe access/egress.
- The pedestrian footpath on this side of the road will also be closed, unless accessing Ashton Lane or the Boyd Orr Building.
- Following the completion of works to the North carriageway, the next phase of works will take place at this section on the South carriageway of University Avenue and will last until March 2021.



## Campus Development

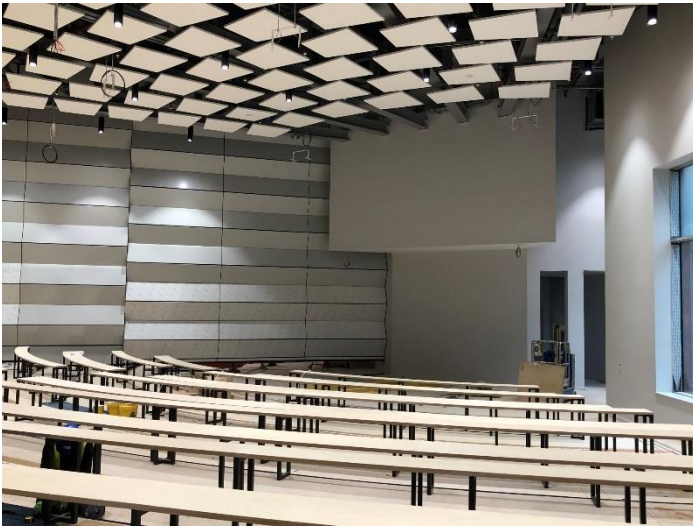

*James McCune Smith Learning Hub*



*Public realm works outside the Research Hub*



*Research Hub services installation*



*Gardiner Institute wrapped for demolition*

## Look Ahead

- External landscaping outside the Wolfson Building and James McCune Smith will continue.
- Over-cladding to the lower levels and lecture theatres at the Boyd Orr Building is ongoing.
- Scaffolding is being erected at the Gardiner Institute to facilitate the upcoming demolition. Demolition along Church St is continuing which will open the Western Campus to pedestrians as part of the overall public realm strategy.
- Drainage diversion works are taking place on Church St and will last for 4 weeks. The current traffic management system will not change.

Built for **positive impact**

## Contacts

[community@multiplex.global](mailto:community@multiplex.global)



**Kieran Ronnie**  
Social Value &  
Community Manager  
[Kieran.Ronnie@multiplex.global](mailto:Kieran.Ronnie@multiplex.global)



**Fergus Shaw**  
Construction Director  
[Fergus.Shaw@multiplex.global](mailto:Fergus.Shaw@multiplex.global)

## Site Working Hours

Monday to Friday: 7:30am – 9pm

Saturday: 7:30am – 5pm



**Registered site**  
[www.ccscheme.org.uk](http://www.ccscheme.org.uk)